

# Premium Booth 3mW x 3mD One side open

## For Home InStyle only

SD-A-9  
3mW x 3mD x 3.5mH

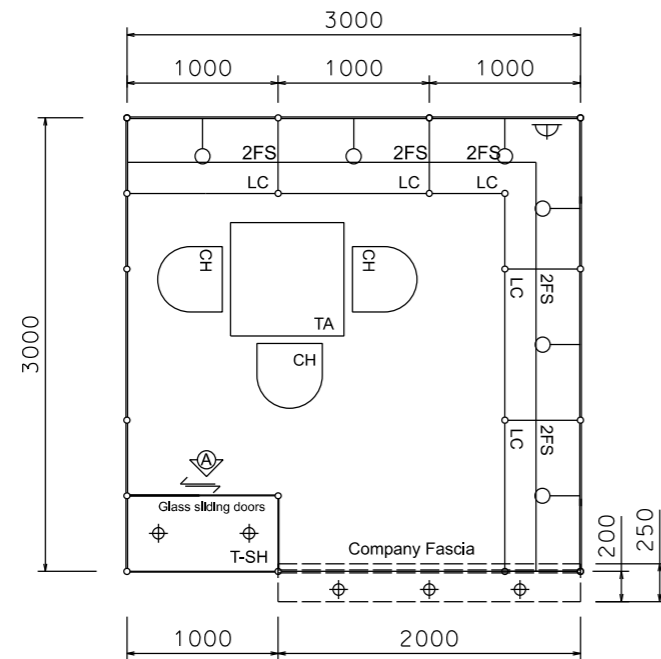

PLAN

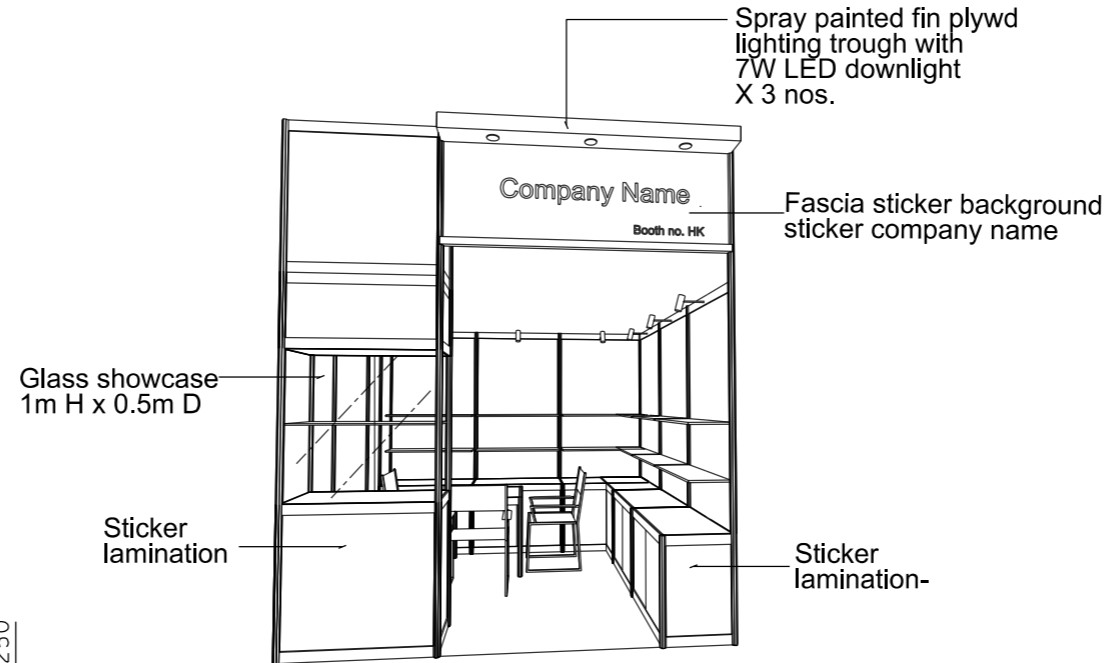

PERSPECTIVE N.T.S.

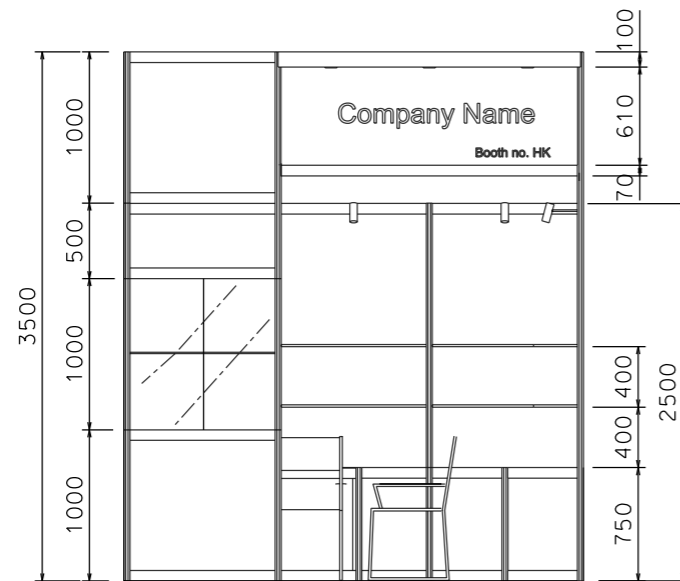

FRONT ELEVATION

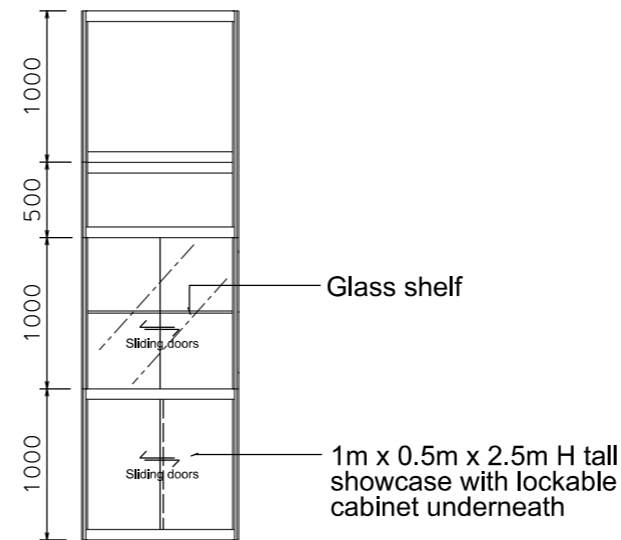

VIEW A

BOOTH SPECIFICATION		QTY
	Tall showcase in beige sticker lamination, 1 layer of glass shelf, 2x 7W LED downlights	1
	Lockable cabinet in beige sticker lamination (1mL x 0.5mD x 0.75mH)	5.5
	Wooden shelf (flat) (1mL x 0.3mD)	12
	Square meeting table (0.7m X0.7m x 0.75mH)	1
	Black leather chair	3
	13W LED Lamp Longarmed Spotlight (yellow)	6
	7W LED light (for fascia)	3
	500w Square pin power socket	1
	Company Logo	1

FILE PATH - I:\a-Booth drawing\Local Fair Premium Booth 2011\SD\SD-Layouts\SD-A layout\REFERENCE\_FOR\_HomeInStyle.dgn



NOTES UNLESS OTHERWISE SPECIFIED ALL DIMENSIONS ARE IN MM.

.....  
.....  
.....

.....  
.....  
.....

REVISION  
26-11-08  
31-12-2008  
15-01-2009  
09-02-2009  
12-05-2009  
18-05-2009  
15-07-2009  
21-01-2010  
05-05-2015  
08-01-2019

DATE: 08-01-2019  
SCALE: 1 : 50 (A3)  
DRAWN BY: ..  
CHECKED BY: .....

TITLE  
Premium Booth SD-A-9

PROJECT  
PREMIUM BOOTH 3m x 3m  
DATE: XXXXXXXX

SHEET  
SD-A01