

# Premium Booth 5mW x 3mD One side open

For Home InStyle only

SD-A-W15  
5mW x 3mD x 3.5mH

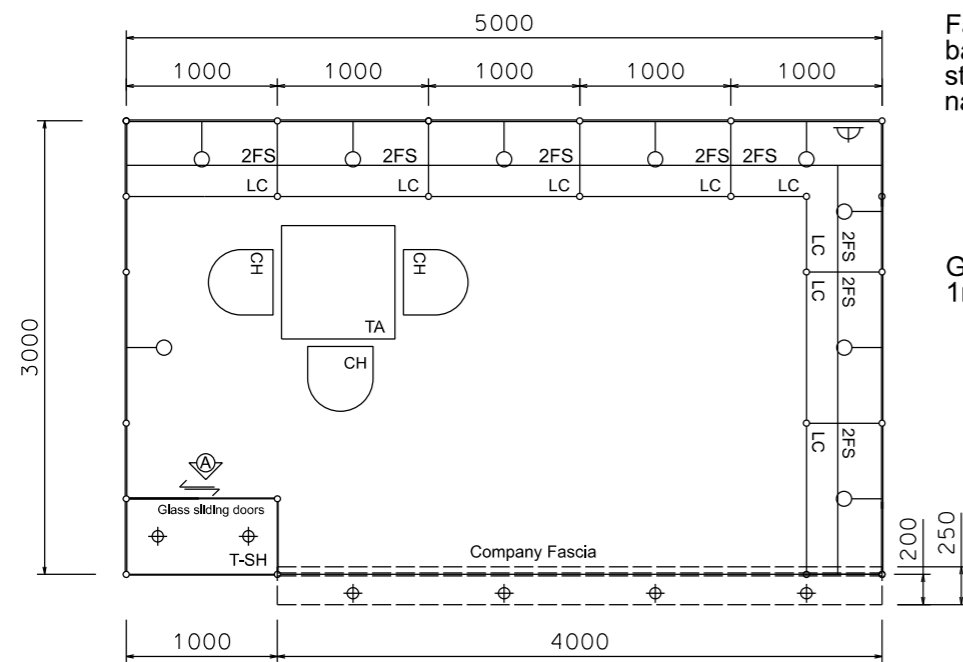

PLAN

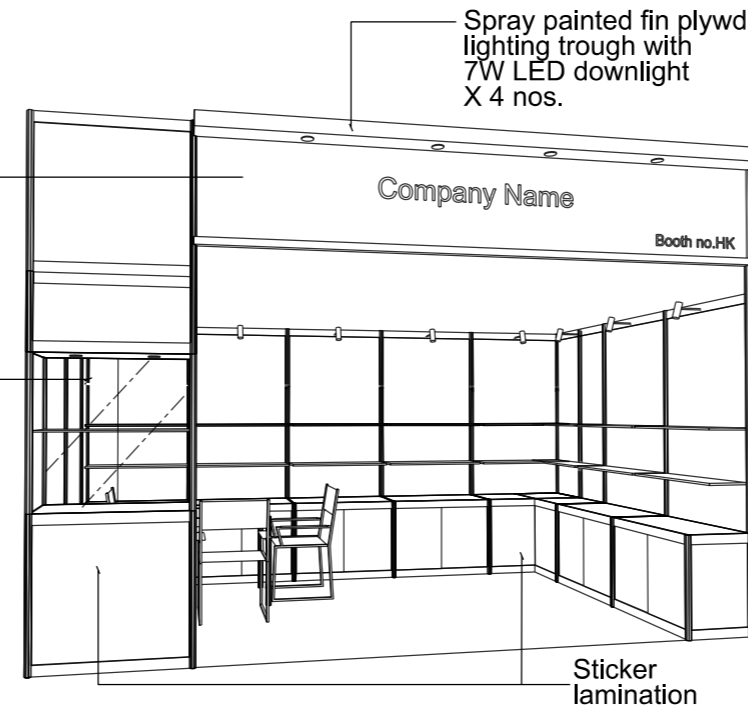

PERSPECTIVE N.T.S

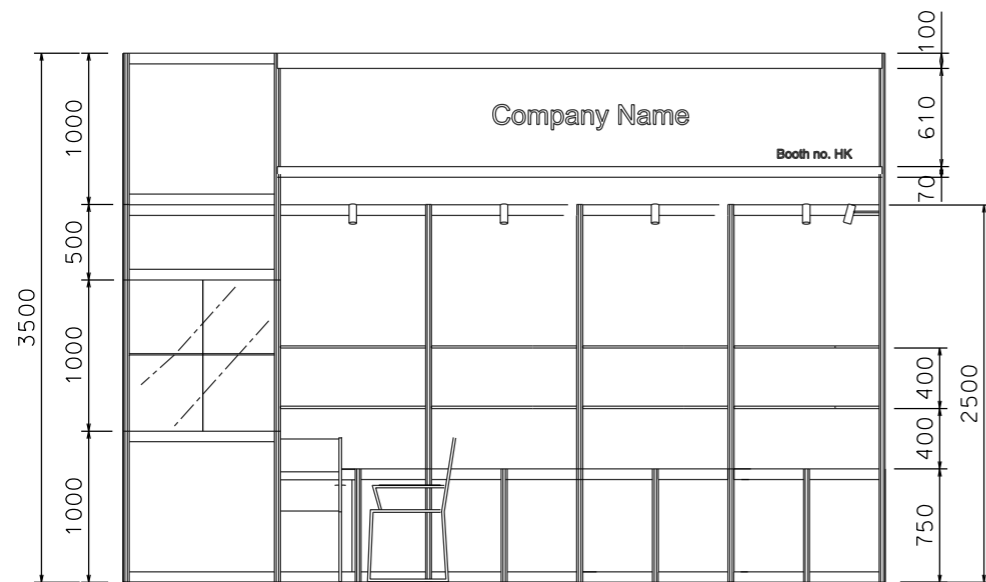

FRONT ELEVATION

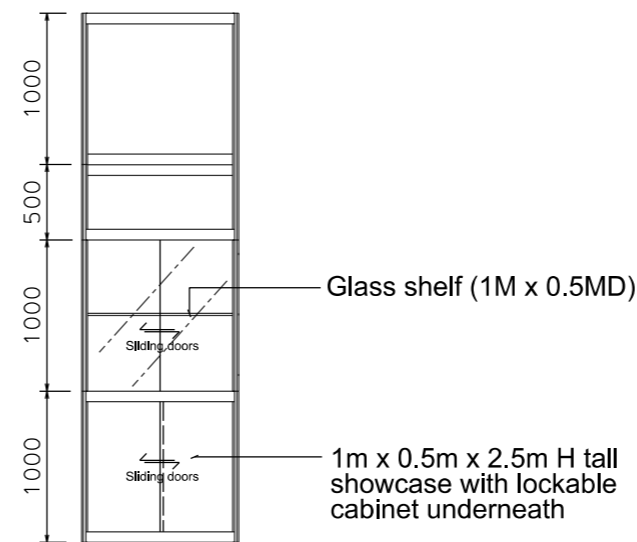

VIEW A

BOOTH SPECIFICATION		QTY
	Tall showcase in beige sticker lamination, 1 layer of glass shelf, 2x 7W LED downlights	1
	Lockable cabinet in beige sticker lamination (1mL x 0.5mD x 0.75mH)	7.5
	Wooden shelf (flat) (1mL x 0.3mD)	16
	Square meeting table (0.7m X0.7m x 0.75mH)	1
	Black leather chair	3
	13W LED Lamp Longarmed Spotlight (yellow)	9
	7W LED light (for fascia)	4
	500w Square pin power socket	1
	Company Logo	1

FILE PATH - I:\a-Booth drawing\Local Fair Premium Booth 2011\SD\SD-Layouts\SD-A layout\REFERENCE\_FOR\_HomeInStyle.dgn



NOTES UNLESS OTHERWISE SPECIFIED ALL DIMENSIONS ARE IN MM.

.....  
.....  
.....

REVISION  
09-02-2009 .  
18-05-2009  
15-07-2009  
21-01-2010  
08-01-2019

DATE: 08-01-2019  
SCALE: 1 : 50 (A3)  
DRAWN BY: ..  
CHECKED BY: .....

TITLE  
Premium Booth  
SD-A-W15

PROJECT  
PREMIUM BOOTH  
5m x 3m  
DATE: XXXXXXXX

SHEET  
SD-A04