

Premium Booth 6mW x 3mD One side open

SD-A-18
6mW x 3mD x 3.5mH

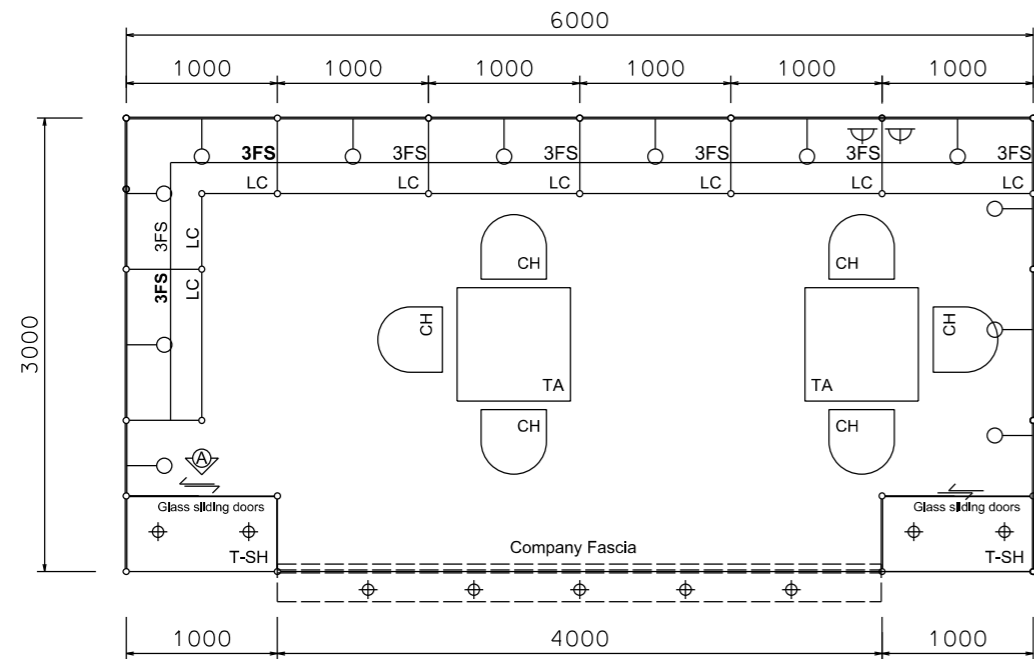

PLAN

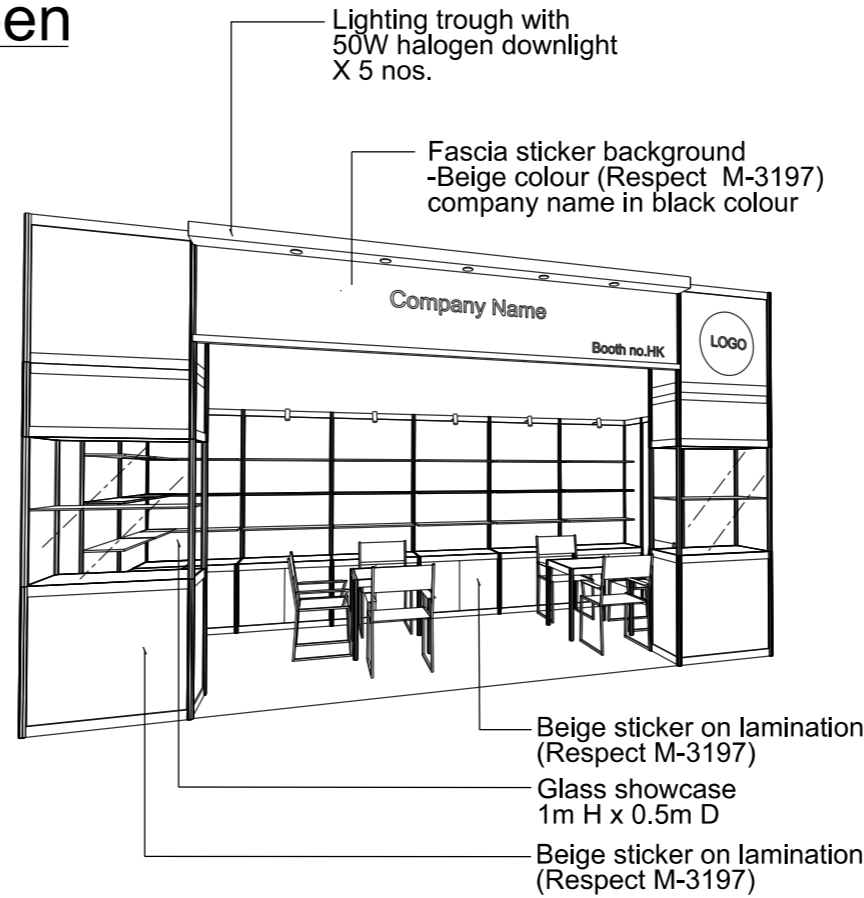

PERSPECTIVE N.T.S



COLOUR PERSPECTIVE N.T.S

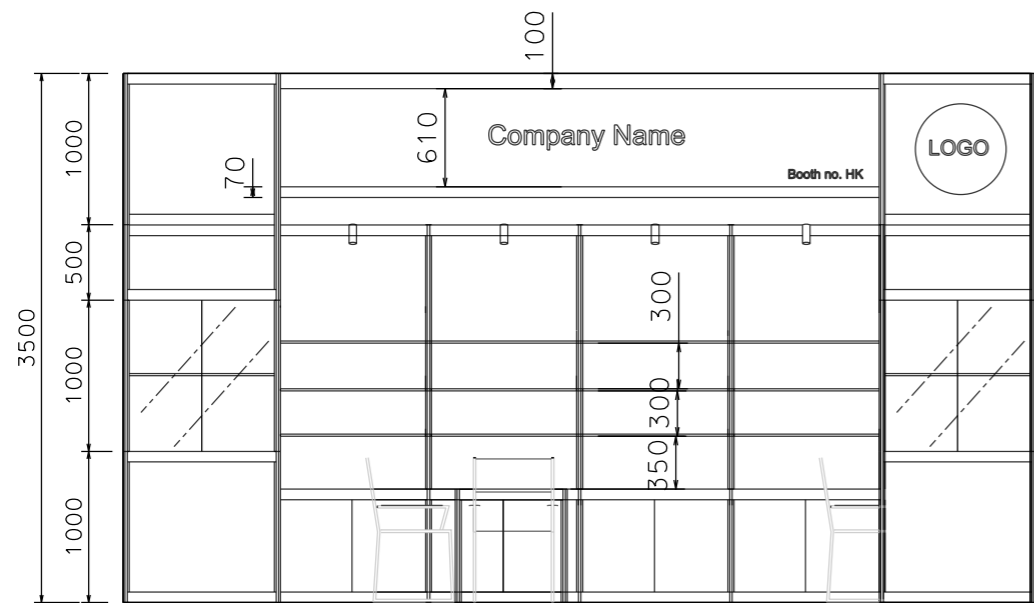

FRONT ELEVATION

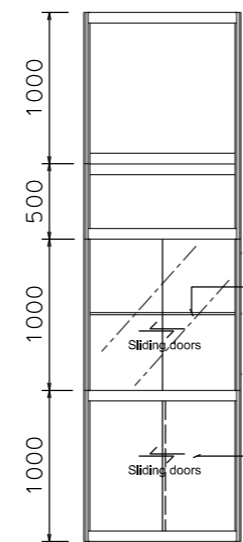

VIEW A

IMPORTANT NOTICE
AMENDMENT OF BOOTH LIGHTING SPECIFICATIONS
ALL LIGHTS SPECIFIED AS 23 WATT ENERGY SAVING LAMPS (BOTH SPOTLIGHT/LONGARMED) ON THIS DRAWING WILL BE CHANGED TO **13 WATT LED LAMPS**, WITH EFFECT ON THE 1st of JANUARY 2019.

BOOTH SPECIFICATION		QTY
	Tall showcase in beige sticker lamination, 1 layer of glass shelf, 2x 50W halogen downlights	2
	Lockable cabinet in beige sticker lamination (1mL x 0.5mD x 0.75mH)	7.5
	Wooden shelf (flat) (1mL x 0.3mD)	24
	Square meeting table (0.7m X0.7m x 0.75mH)	2
	Black leather chair	6
	Longarmed spotlight w/23 watt energy saving lamp (yellow)	12
	50W Halogen light (for fascia)	5
	500w Square pin power socket	2
	Company Logo	1

FILE PATH - L:\Local Fair Premium Booth 2011\SD-Layouts\SD-A layout\SD-A-Layout-New.dgn



NOTES UNLESS OTHERWISE SPECIFIED ALL DIMENSIONS ARE IN MM.

.....
.....
.....

.....
.....
.....

REVISION
26-11-08
31-12-2008
15-01-2009
09-02-2009
11-05-2009
18-05-2009
15-07-2009
21-01-2010
05-05-2015

DATE: 21-01-2010
SCALE: 1 : 50 (A3)
DRAWN BY: ..
CHECKED BY:

TITLE
Premium Booth SD-A-18

PROJECT
PREMIUM BOOTH 6m x 3m
DATE: XXXXXXXX

SHEET
SD-A05

Premium Booth 6mW x 3mD One side open (Special Edition)

SD-A-18
6mW x 3mD x 3.5mH

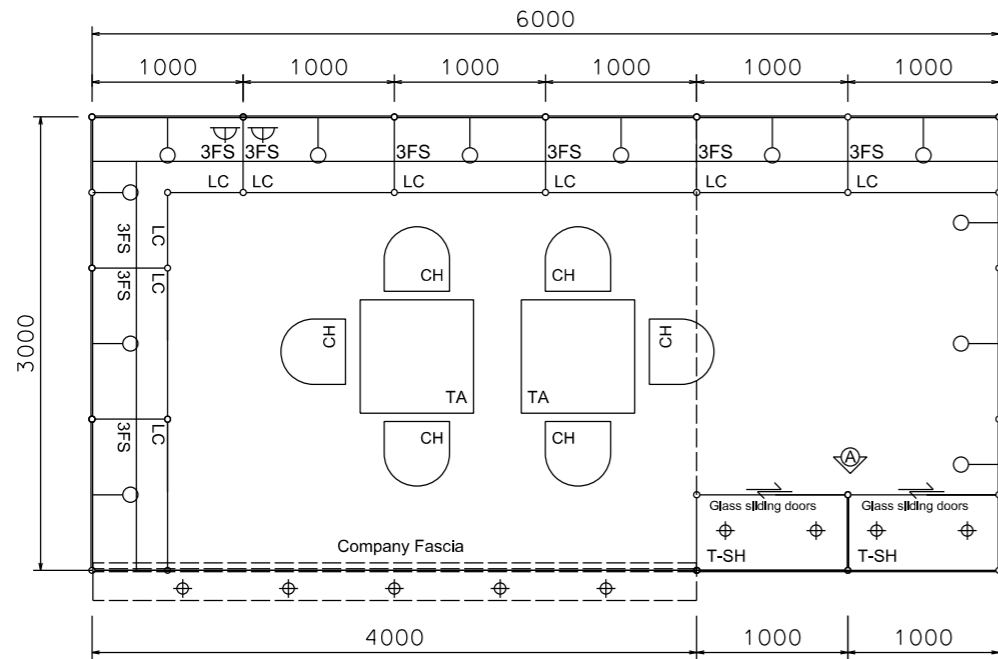

PLAN

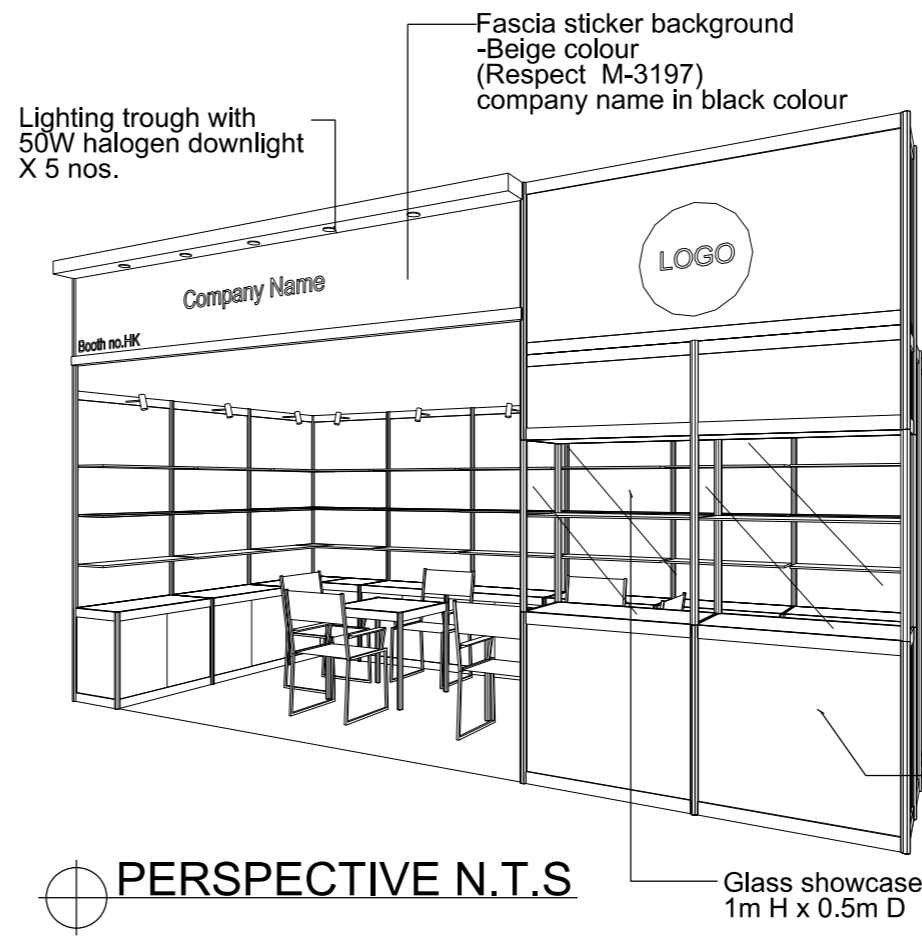

PERSPECTIVE N.T.S



COLOUR PERSPECTIVE N.T.S

IMPORTANT NOTICE
AMENDMENT OF BOOTH LIGHTING SPECIFICATIONS

ALL LIGHTS SPECIFIED AS 23 WATT ENERGY SAVING LAMPS (BOTH SPOTLIGHT/LONGARMED) ON THIS DRAWING WILL BE CHANGED TO 13 WATT LED LAMPS, WITH EFFECT ON THE 1st OF JANUARY 2019.

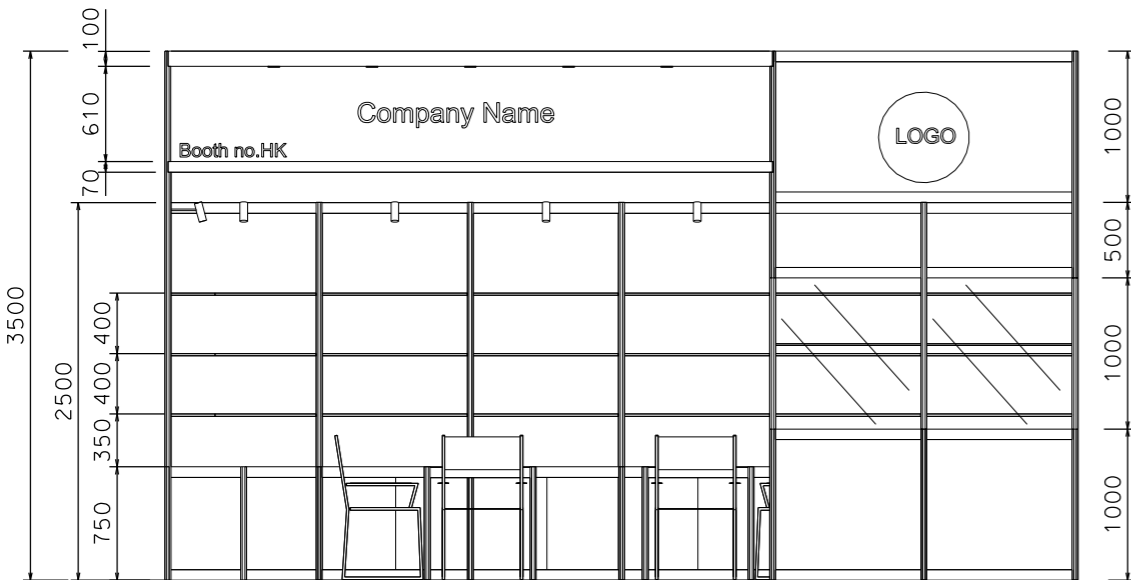

FRONT ELEVATION

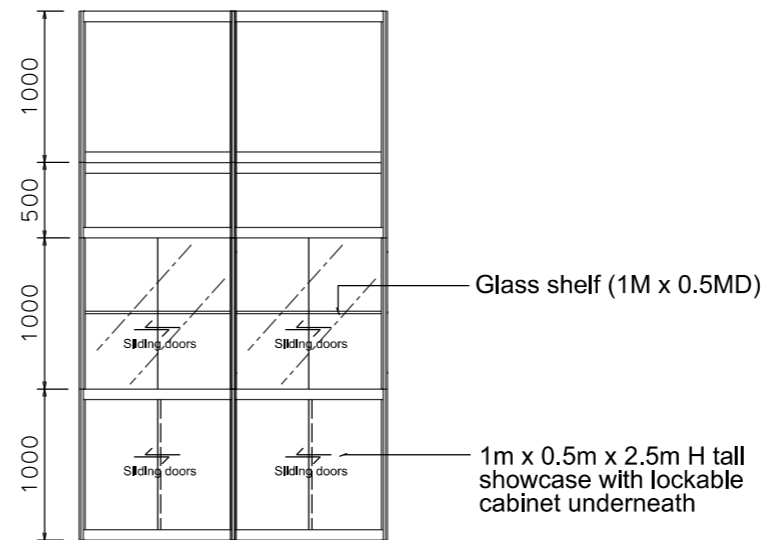

VIEW A

BOOTH SPECIFICATION		QTY
	Tall showcase in beige sticker lamination, 1 layer of glass shelf, 2x 50W halogen downlights	2
	Lockable cabinet in beige sticker lamination (1mL x 0.5mD x 0.75mH)	8.5
	Wooden shelf (flat) (1mL x 0.3mD)	27
	Square meeting table (0.7m X0.7m x 0.75mH)	2
	Black leather chair	6
	Longarmed spotlight w/23 watt energy saving lamp (yellow)	12
	50W Halogen light (for fascia)	5
	500w Square pin power socket	2
	Company Logo	1

FILE PATH - L:\Local Fair Premium Booth 2011\SD-Layouts\SD-A layout\SD-A-Layout-New.dgn



NOTES UNLESS OTHERWISE SPECIFIED ALL DIMENSIONS ARE IN MM.

REVISION 06-12-2014 .

DATE: 06-12-2014
SCALE: 1 : 50 (A3)
DRAWN BY: ..
CHECKED BY:

TITLE
Premium Booth SD-A-18

PROJECT
PREMIUM BOOTH 6m x 3m
DATE: XXXXXXXX

SHEET

SD-A05f

IMPORTANT NOTICE
AMENDMENT OF BOOTH LIGHTING SPECIFICATIONS

ALL LIGHTS SPECIFIED AS 23 WATT ENERGY SAVING LAMPS (BOTH SPOTLIGHT/LONGARMED) ON THIS DRAWING WILL BE CHANGED TO **13 WATT LED LAMPS**, WITH EFFECT ON THE 1st of JANUARY 2019.

Premium Booth 6mW x 3mD Left side Corner Booth

SD-A-18-L Cnr
 6mW x 3mD x 3.5mH

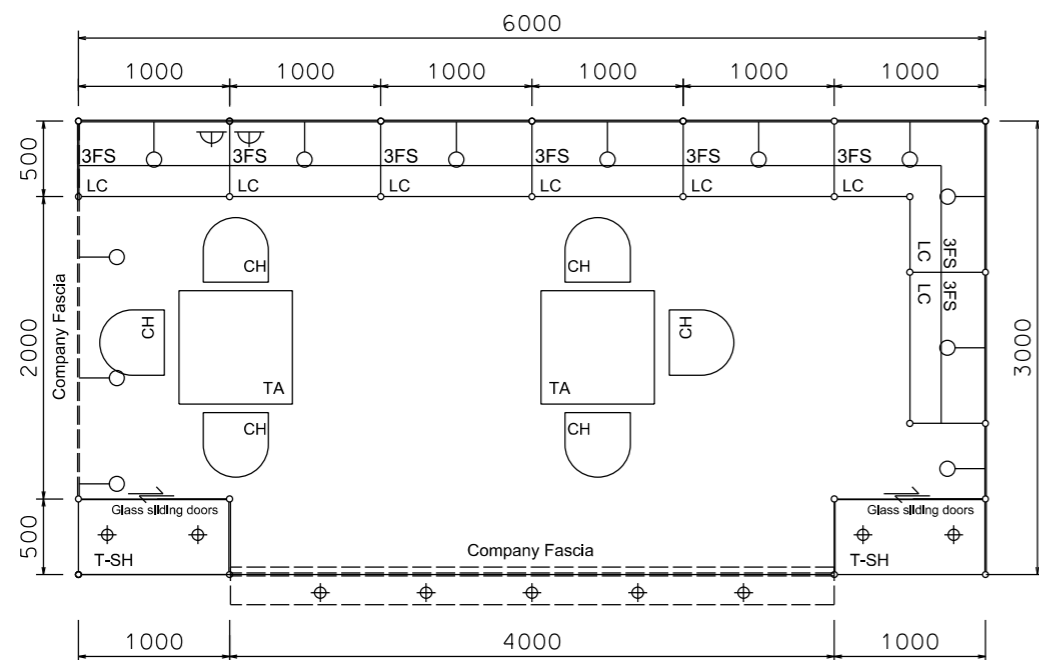

PLAN

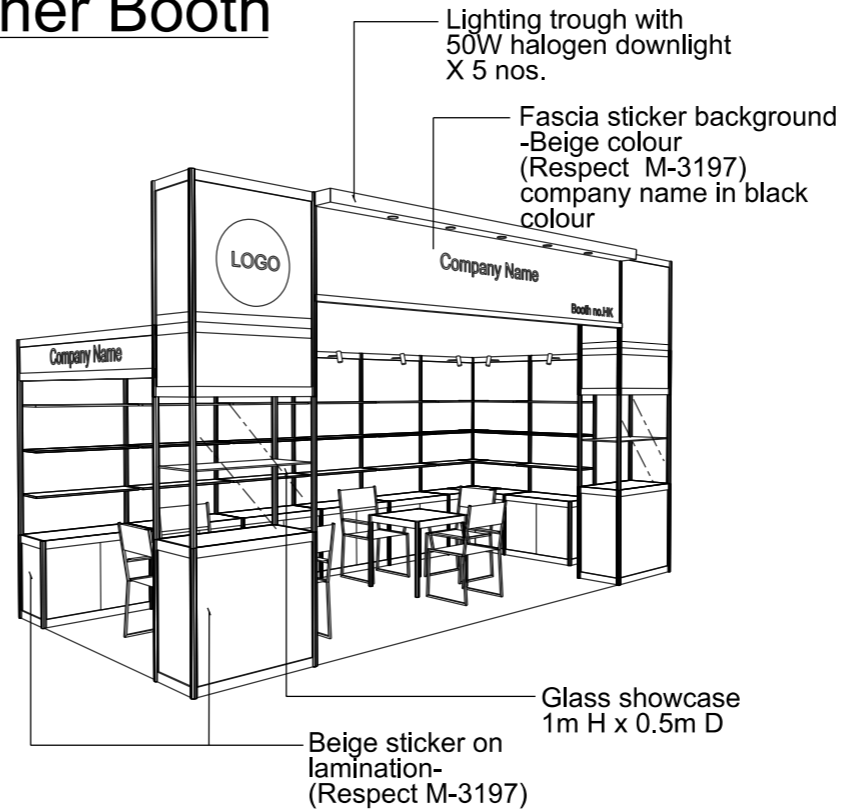

PERSPECTIVE N.T.S



COLOUR PERSPECTIVE N.T.S

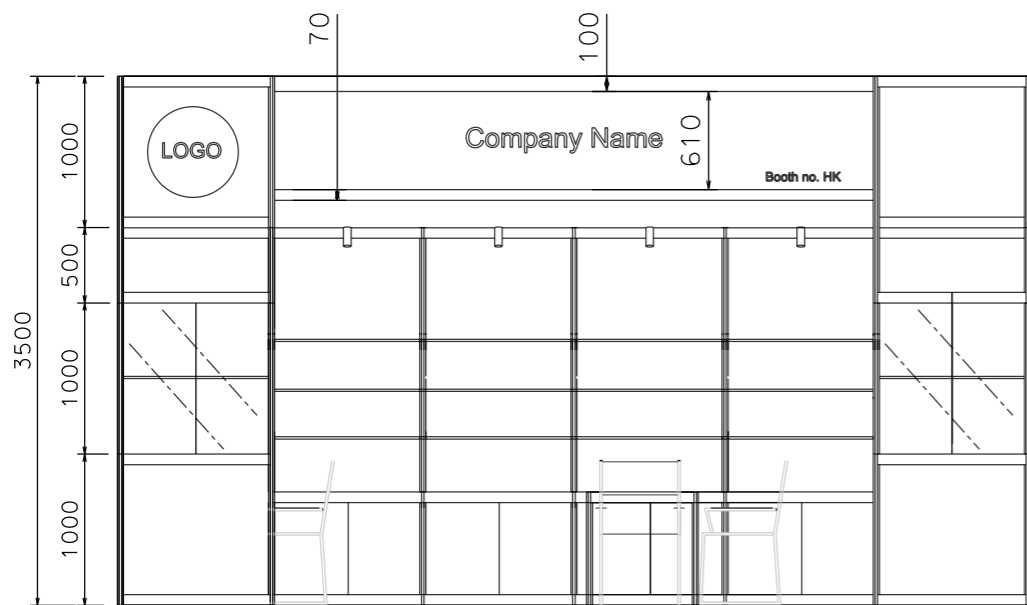

FRONT ELEVATION

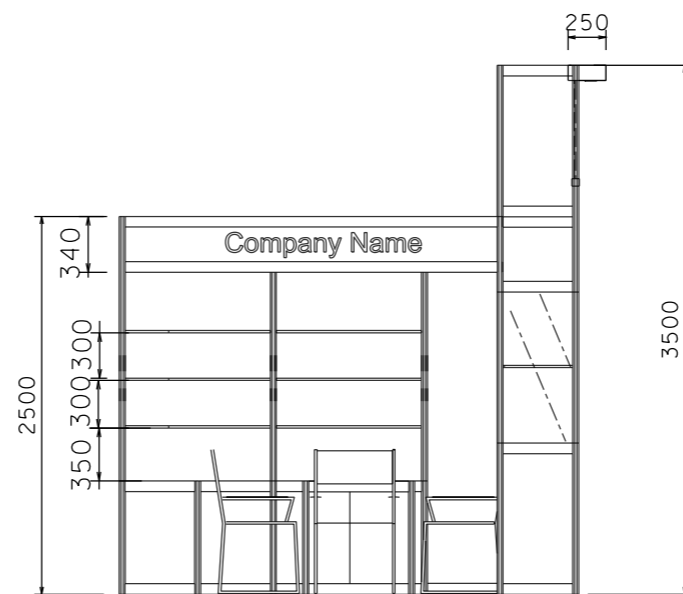

SIDE ELEVATION

BOOTH SPECIFICATION	QTY
Tall showcase in beige sticker lamination, 1 layer of glass shelf, 2x 50W halogen downlights	2
Lockable cabinet in beige sticker lamination (1mL x 0.5mD x 0.75mH)	7.5
Wooden shelf (flat) (1mL x 0.3mD)	24
Square meeting table (0.7m X0.7m x 0.75mH)	2
Black leather chair	6
Longarmed spotlight w/23 watt energy saving lamp (yellow)	12
50W Halogen light (for fascia)	5
500w Square pin power socket	2
Company Logo	1

FILE PATH - L:\Local Fair Premium Booth 2011\SD-Layouts\SD-A-Layout-New.dgn



NOTES UNLESS OTHERWISE SPECIFIED ALL DIMENSIONS ARE IN MM.

.....

.....

.....

REVISION	DATE
26-11-08	
31-12-2008	
15-01-2009	
09-02-2009	
18-05-2009	
15-07-2009	
21-01-2010	
05-05-2015	

DATE:	21-01-2010
SCALE:	1 : 50 (A3)
DRAWN BY:	..
CHECKED BY:

TITLE

Premium Booth
 SD-A-18L
 Corner

PROJECT

PREMIUM BOOTH
 6m x 3m
 Corner

DATE: XXXXXXXX

SHEET

SD-A05a

Premium Booth 6mW x 3mD Right side open Corner Booth

SD-A-18-R Cnr
6mW x 3mD x 3.5mH

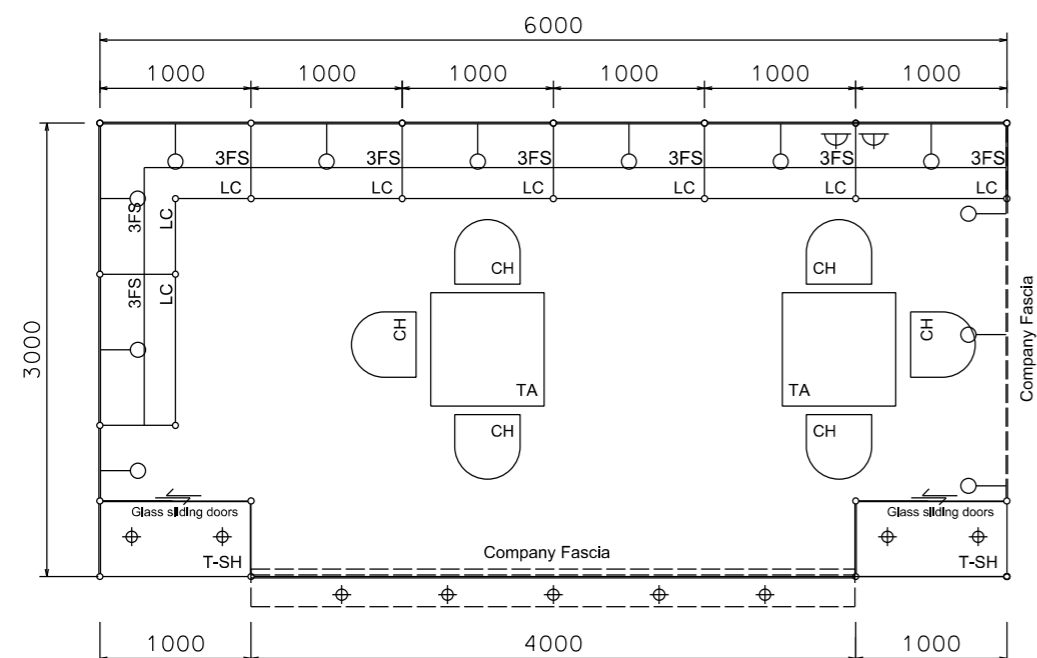

PLAN

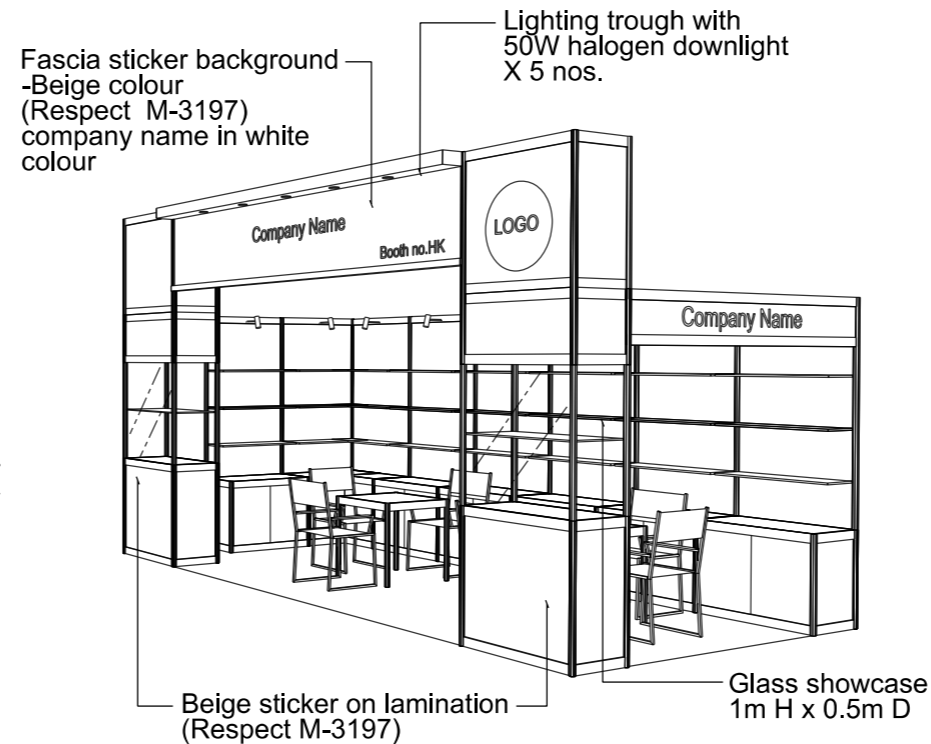

PERSPECTIVE N.T.S



COLOUR PERSPECTIVE N.T.S

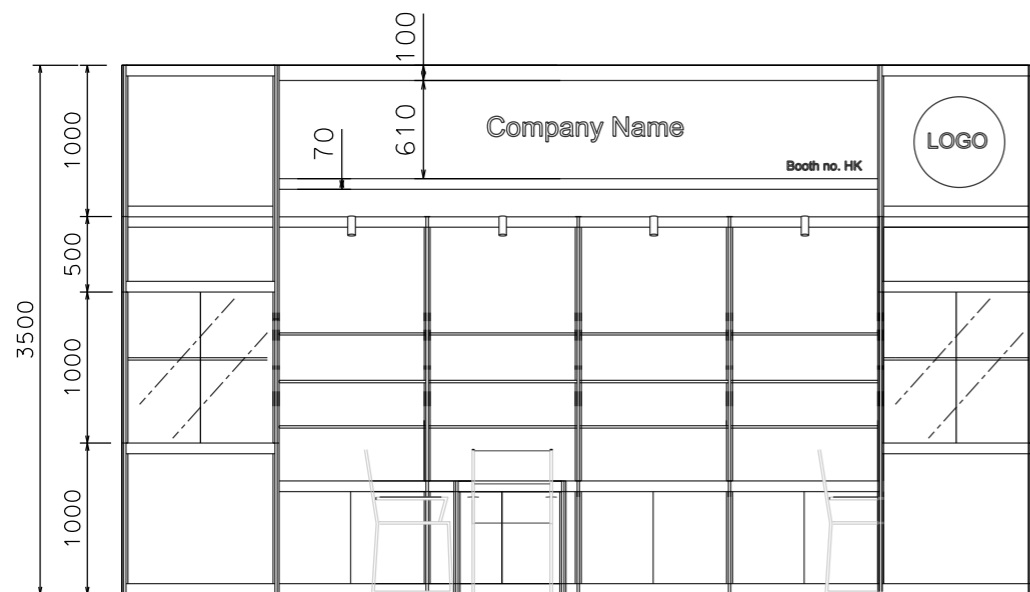

FRONT ELEVATION

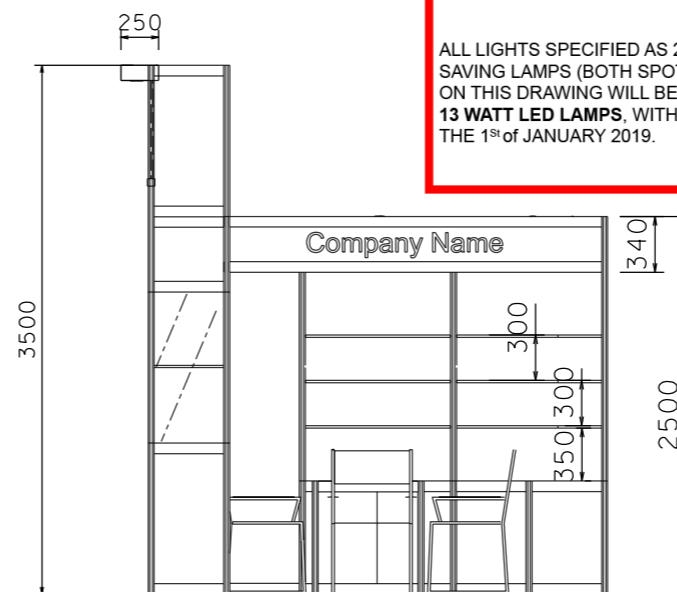

SIDE ELEVATION

IMPORTANT NOTICE
AMENDMENT OF BOOTH LIGHTING SPECIFICATIONS
ALL LIGHTS SPECIFIED AS 23 WATT ENERGY SAVING LAMPS (BOTH SPOTLIGHT/LONGARMED) ON THIS DRAWING WILL BE CHANGED TO **13 WATT LED LAMPS**, WITH EFFECT ON THE 1st of JANUARY 2019.

BOOTH SPECIFICATION		QTY
	Tall showcase in beige sticker lamination, 1 layer of glass shelf, 2x 50W halogen downlights	2
	Lockable cabinet in beige sticker lamination (1mL x 0.5mD x 0.75mH)	7.5
	Wooden shelf (flat) (1mL x 0.3mD)	24
	Square meeting table (0.7m X0.7m x 0.75mH)	2
	Black leather chair	6
	Longarmed spotlight w/23 watt energy saving lamp (yellow)	12
	50W Halogen light (for fascia)	5
	500w Square pin power socket	2
	Company Logo	1

FILE PATH - L:\Local Fair Premium Booth 2011\SD-Layouts\SD-A-Layout-New.dgn



NOTES UNLESS OTHERWISE SPECIFIED ALL DIMENSIONS ARE IN MM.

.....
.....
.....

REVISION
26-11-08
31-12-2008
15-01-2009
09-02-2009
18-05-2009
15-07-2009
21-01-2010
05-05-2015

DATE: 21-01-2010
SCALE: 1 : 50 (A3)
DRAWN BY: ..
CHECKED BY:

TITLE
Premium Booth SD-A-18R Corner

PROJECT
PREMIUM BOOTH 6m x 3m Corner
DATE: XXXXXXXX

SHEET
SD-A05b

Premium Booth 6mW x 3mD 2 Sides Open

SD-A-18
6mW x 3mD x 3.5mH

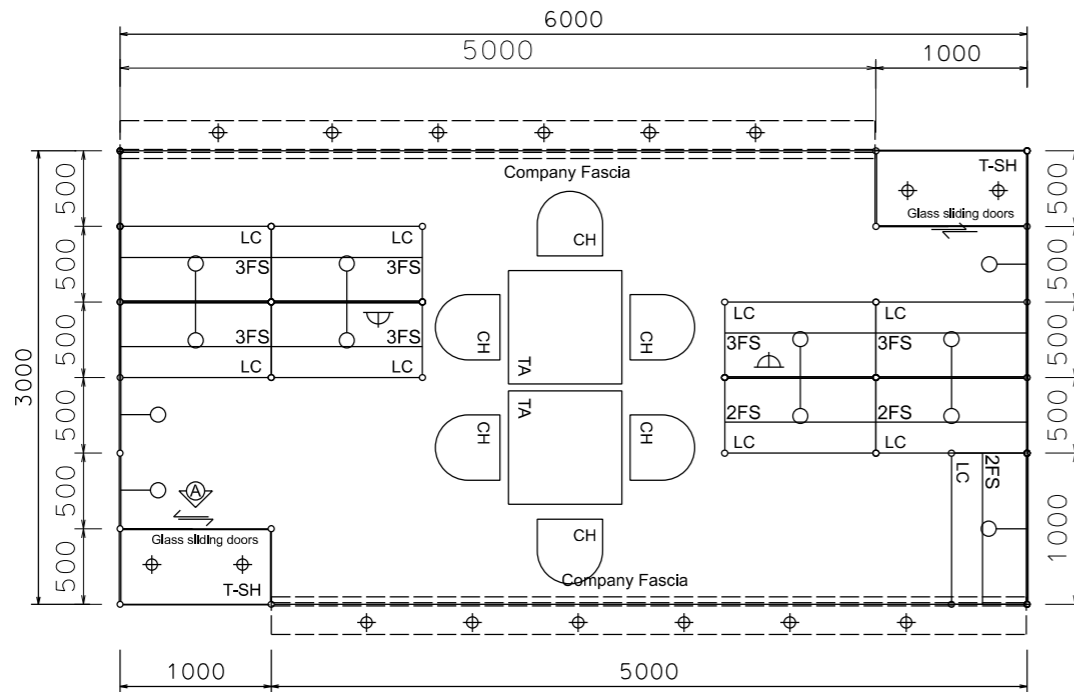

PLAN

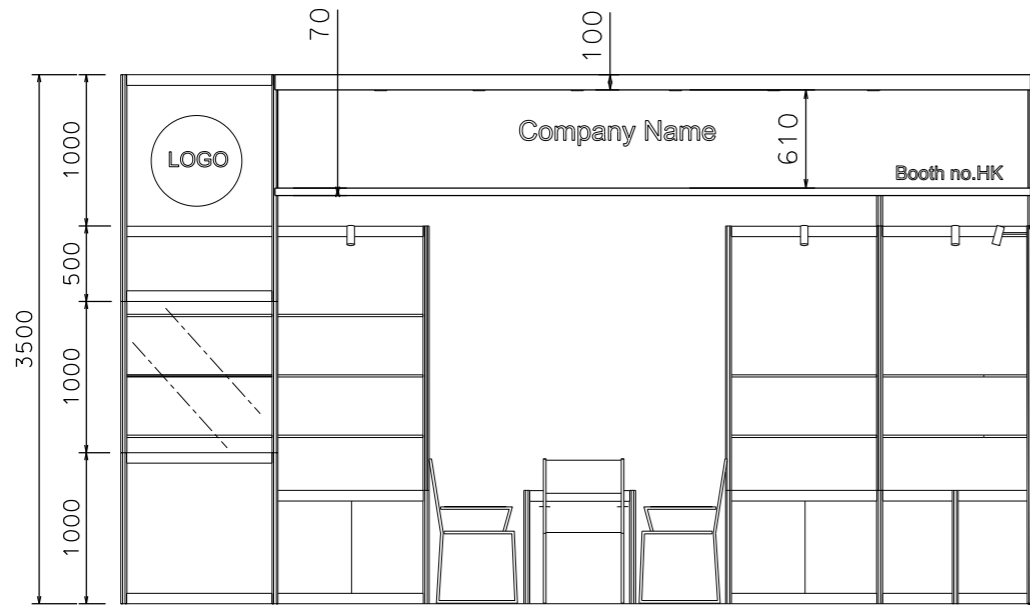

FRONT ELEVATION

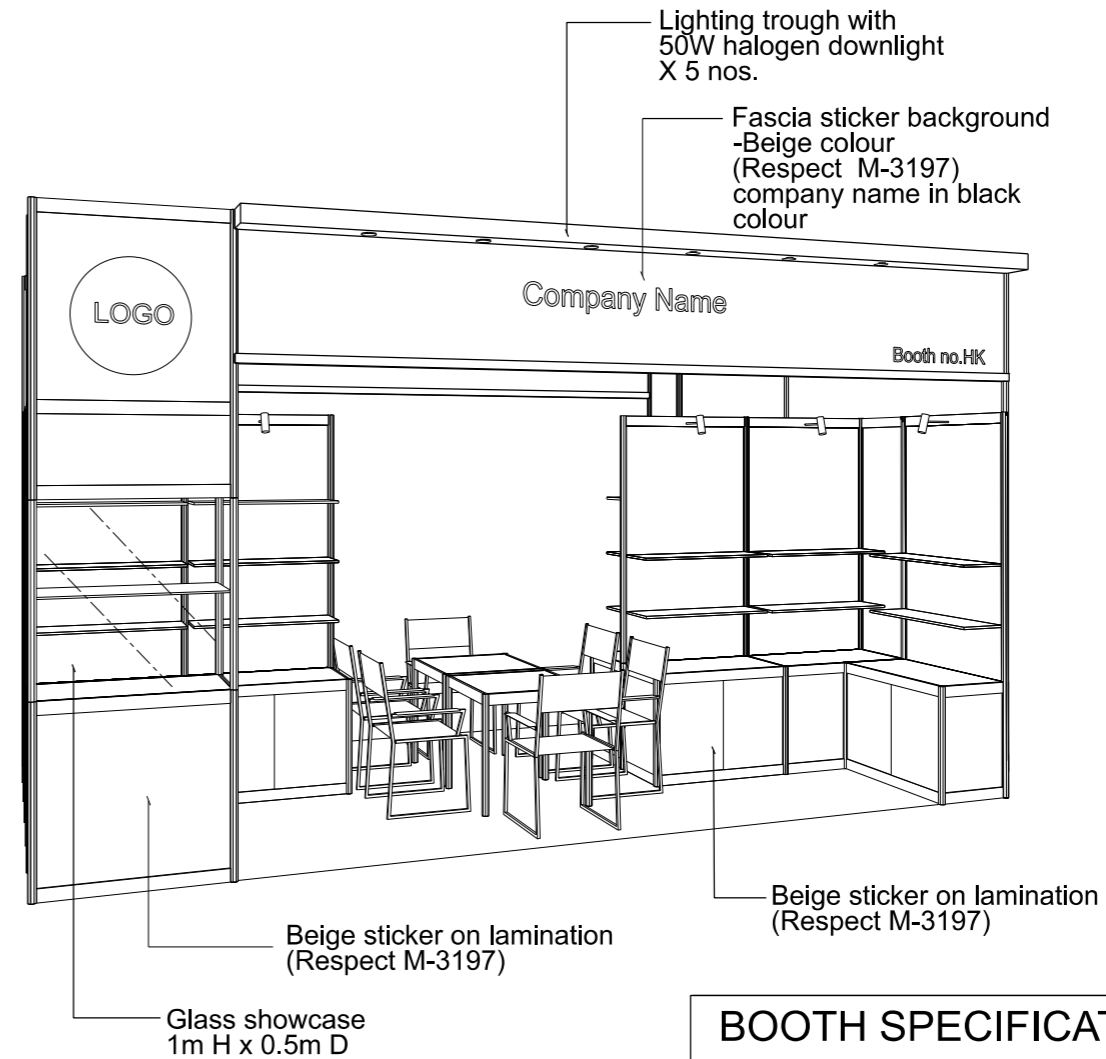

PERSPECTIVE N.T.S

IMPORTANT NOTICE
AMENDMENT OF BOOTH LIGHTING SPECIFICATIONS

ALL LIGHTS SPECIFIED AS 23 WATT ENERGY SAVING LAMPS (BOTH SPOTLIGHT/LONGARMED) ON THIS DRAWING WILL BE CHANGED TO **13 WATT LED LAMPS**, WITH EFFECT ON THE 1ST OF JANUARY 2019.

BOOTH SPECIFICATION		QTY
	Tall showcase in beige sticker lamination, 1 layer of glass shelf, 2x 50W halogen downlights	2
	Lockable cabinet in beige sticker lamination (1mL x 0.5mD x 0.75mH)	9
	Wooden shelf (flat) (1mL x 0.3mD)	24
	Square meeting table (0.7m X0.7m x 0.75mH)	2
	Black leather chair	6
	Longarmed spotlight w/23 watt energy saving lamp (yellow)	12
	50W Halogen light (for fascia)	10
	500w Square pin power socket	2
	Company Logo	2

FILE PATH - L:\Local For Premium Booth 2017\SD-Layouts\SD-A layout\SD-A-Layout_New.dgn

<p>HKTDC 香港貿易局</p>	<p>NOTES UNLESS OTHERWISE SPECIFIED ALL DIMENSIONS ARE IN MM.</p> <p>.....</p> <p>.....</p> <p>.....</p>	<p>REVISION 12-12-2017</p>	<p>DATE: 12-12-2017</p> <p>SCALE: 1 : 50 (A3)</p> <p>DRAWN BY: ..</p> <p>CHECKED BY:</p>	<p>TITLE</p> <p>Premium Booth SD-A-18</p>	<p>PROJECT</p> <p>PREMIUM BOOTH 6m x 3m</p> <p>DATE: XXXXXXXX</p>	<p>SHEET</p> <p style="font-size: 2em; font-weight: bold;">SD-A05</p>
	<p>DATE: 15-Dec-17 2:50:21 PM</p>					

Premium Booth 6mW x 3mD 3 side open

SD-A-18
6mW x 3mD x 3.5mH

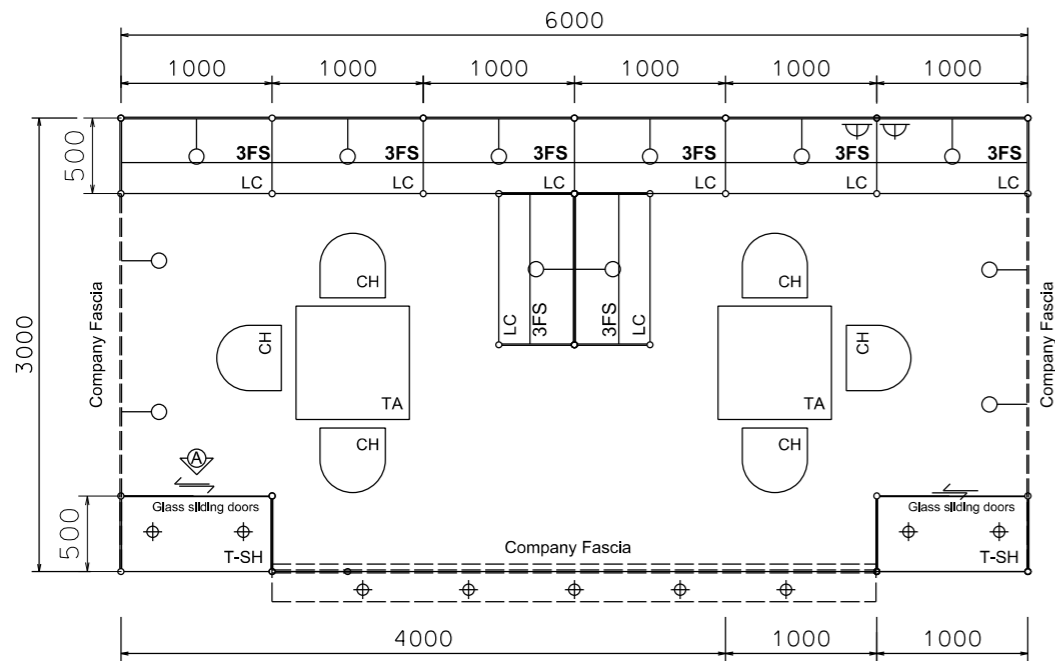

PLAN

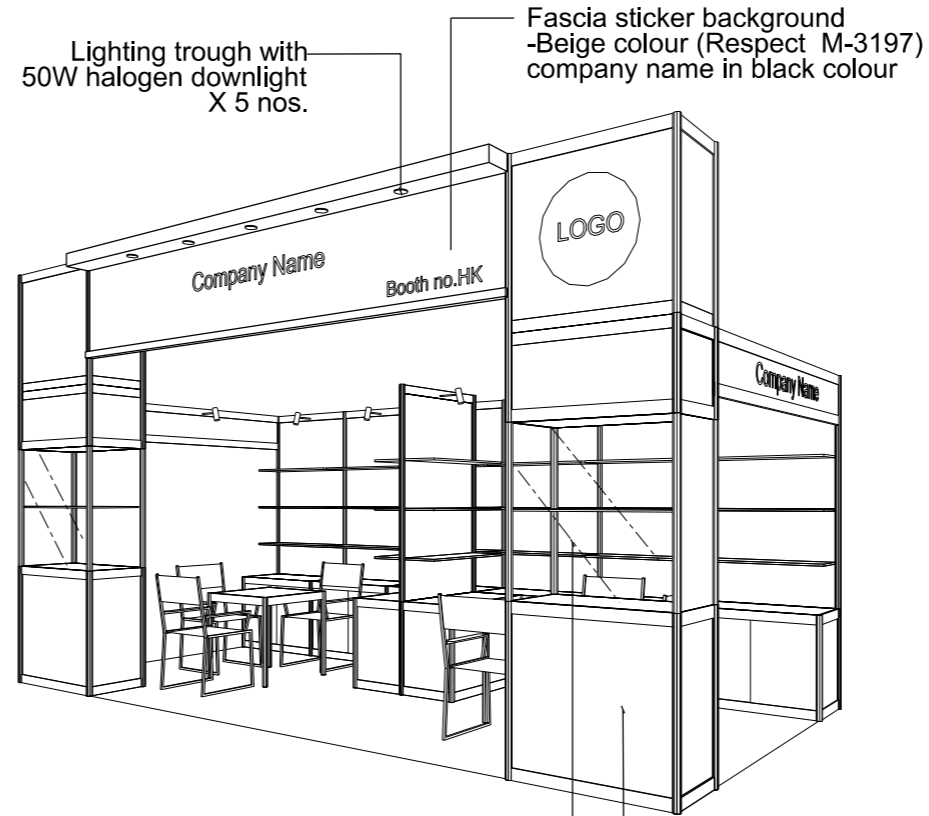

PERSPECTIVE N.T.S



COLOUR PERSPECTIVE N.T.S

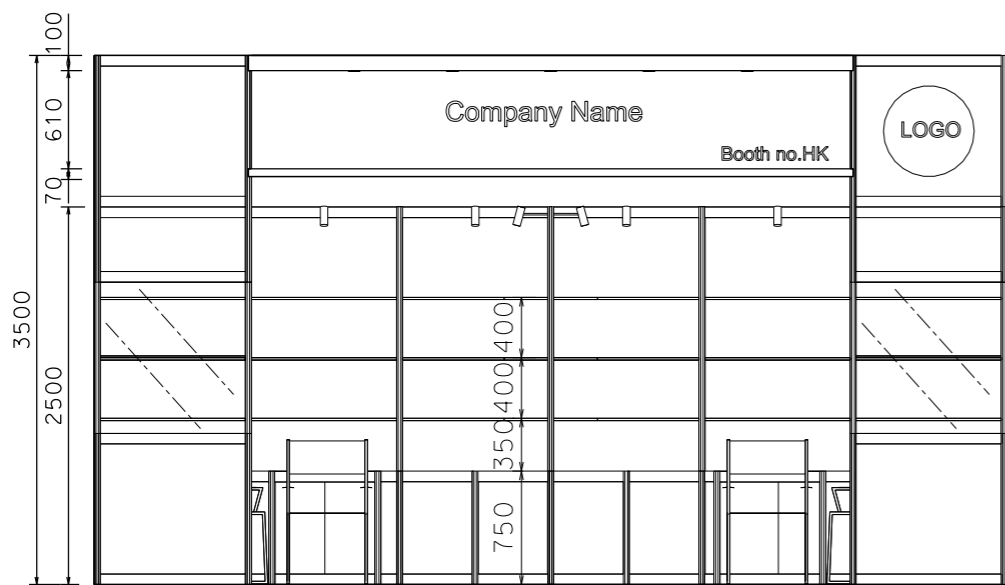

FRONT ELEVATION

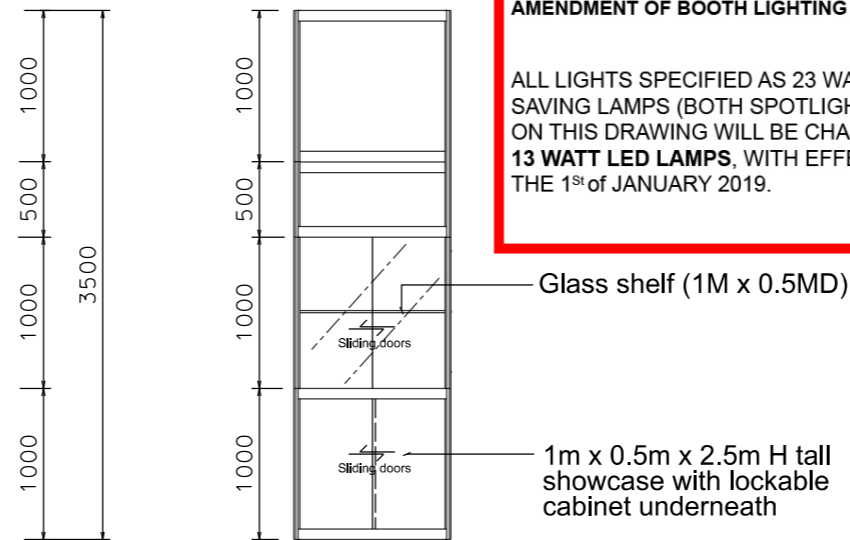

VIEW A

IMPORTANT NOTICE
AMENDMENT OF BOOTH LIGHTING SPECIFICATIONS
ALL LIGHTS SPECIFIED AS 23 WATT ENERGY SAVING LAMPS (BOTH SPOTLIGHT/LONGARMED) ON THIS DRAWING WILL BE CHANGED TO **13 WATT LED LAMPS**, WITH EFFECT ON THE 1st of JANUARY 2019.

BOOTH SPECIFICATION		QTY
	Tall showcase in beige sticker lamination, 1 layer of glass shelf, 2x 50W halogen downlights	2
	Lockable cabinet in beige sticker lamination (1mL x 0.5mD x 0.75mH)	8
	Wooden shelf (flat) (1mL x 0.3mD)	24
	Square meeting table (0.7m X0.7m x 0.75mH)	2
	Black leather chair	6
	Longarmed spotlight w/23 watt energy saving lamp (yellow)	12
	50W Halogen light (for fascia)	5
	500w Square pin power socket	2
	Company Logo	1

FILE PATH - L:\Local Fair Premium Booth 2011\SD-Layouts\SD-A layout\SD-A-Layout-New.dgn



NOTES UNLESS OTHERWISE SPECIFIED ALL DIMENSIONS ARE IN MM.

.....
.....
.....

.....
.....
.....

REVISION 10-12-2014 .

DATE: 10-12-2014
SCALE: 1 : 50 (A3)
DRAWN BY: ..
CHECKED BY:

TITLE
Premium Booth SD-A-18

PROJECT
PREMIUM BOOTH 6m x 3m
DATE: XXXXXXXX

SHEET

SD-A05