

Premium Booth 3mW x 3mD One side open

SD-A-9
3mW x 3mD x 3.5mH

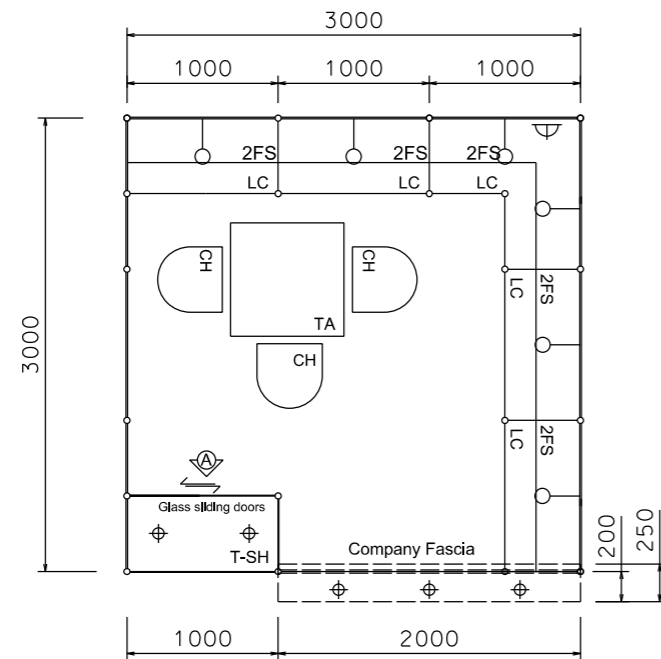

PLAN

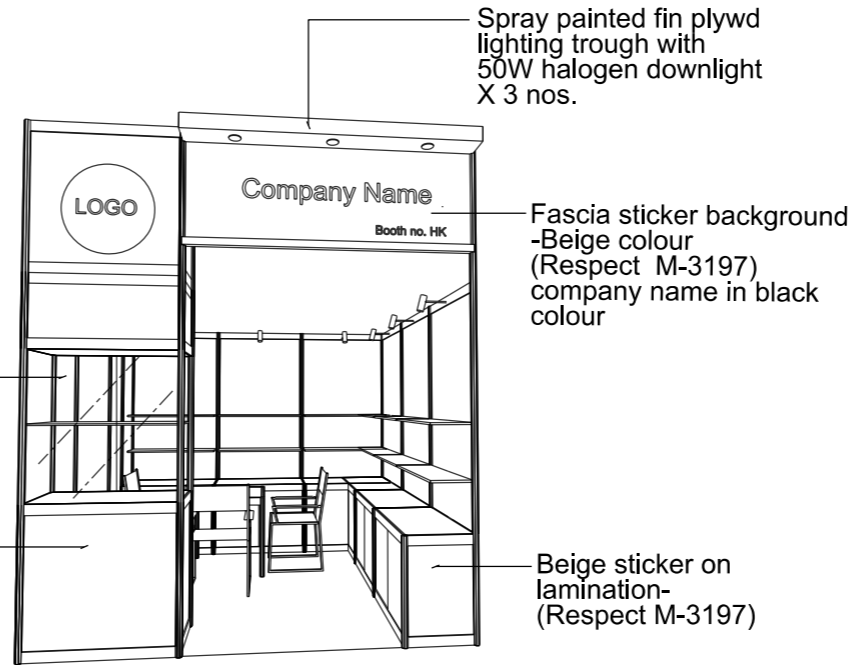

PERSPECTIVE N.T.S



COLOUR PERSPECTIVE N.T.S

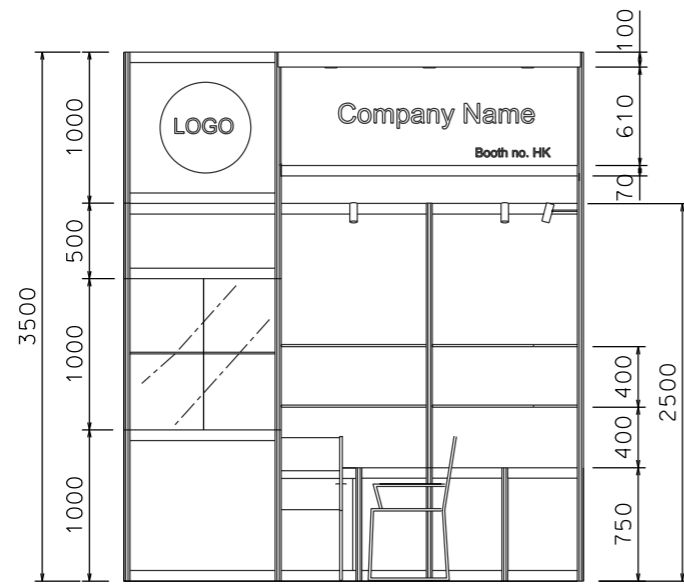

FRONT ELEVATION

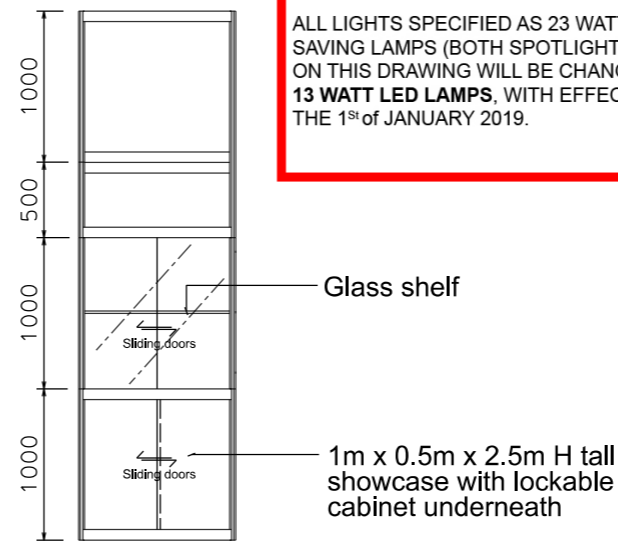

VIEW A

IMPORTANT NOTICE
AMENDMENT OF BOOTH LIGHTING SPECIFICATIONS

ALL LIGHTS SPECIFIED AS 23 WATT ENERGY SAVING LAMPS (BOTH SPOTLIGHT/LONGARMED) ON THIS DRAWING WILL BE CHANGED TO 13 WATT LED LAMPS, WITH EFFECT ON THE 1st OF JANUARY 2019.

BOOTH SPECIFICATION		QTY
	Tall showcase in beige sticker lamination, 1 layer of glass shelf, 2x 50W halogen downlights	1
	Lockable cabinet in beige sticker lamination (1mL x 0.5mD x 0.75mH)	5.5
	Wooden shelf (flat) (1mL x 0.3mD)	12
	Square meeting table (0.7m X0.7m x 0.75mH)	1
	Black leather chair	3
	Longarmed spotlight w/23 watt energy saving lamp (yellow)	6
	50W Halogen light (for fascia)	3
	500w Square pin power socket	1
	Company Logo	1

FILE PATH - L:\Local Fair Premium Booth 2011\SD-Layouts\SD-A layout\SD-A-Layout-New.dgn



NOTES UNLESS OTHERWISE SPECIFIED ALL DIMENSIONS ARE IN MM.

.....
.....
.....

REVISION
26-11-08
31-12-2008
15-01-2009
09-02-2009
12-05-2009
18-05-2009
15-07-2009
21-01-2010
05-05-2015

DATE: 21-01-2010
SCALE: 1 : 50 (A3)
DRAWN BY: ..
CHECKED BY:

TITLE
Premium Booth SD-A-9

PROJECT
PREMIUM BOOTH 3m x 3m
DATE: XXXXXXXX

SHEET
SD-A01

Premium Booth 3mW x 3mD Two sides open

SD-A-9
3mW x 3mD x 3.5mH

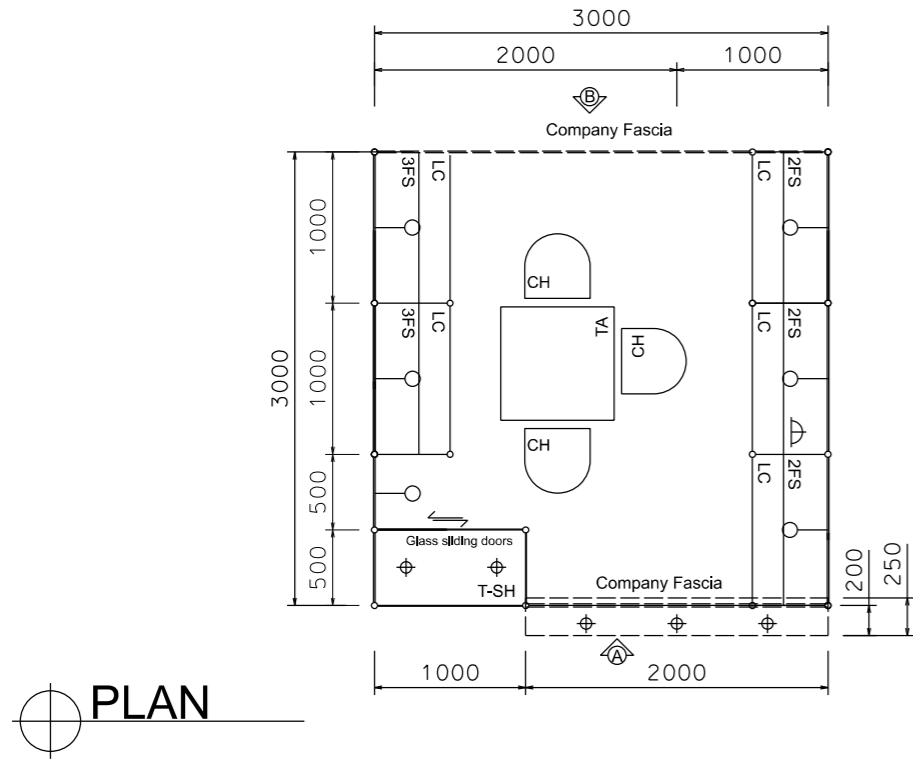

PLAN

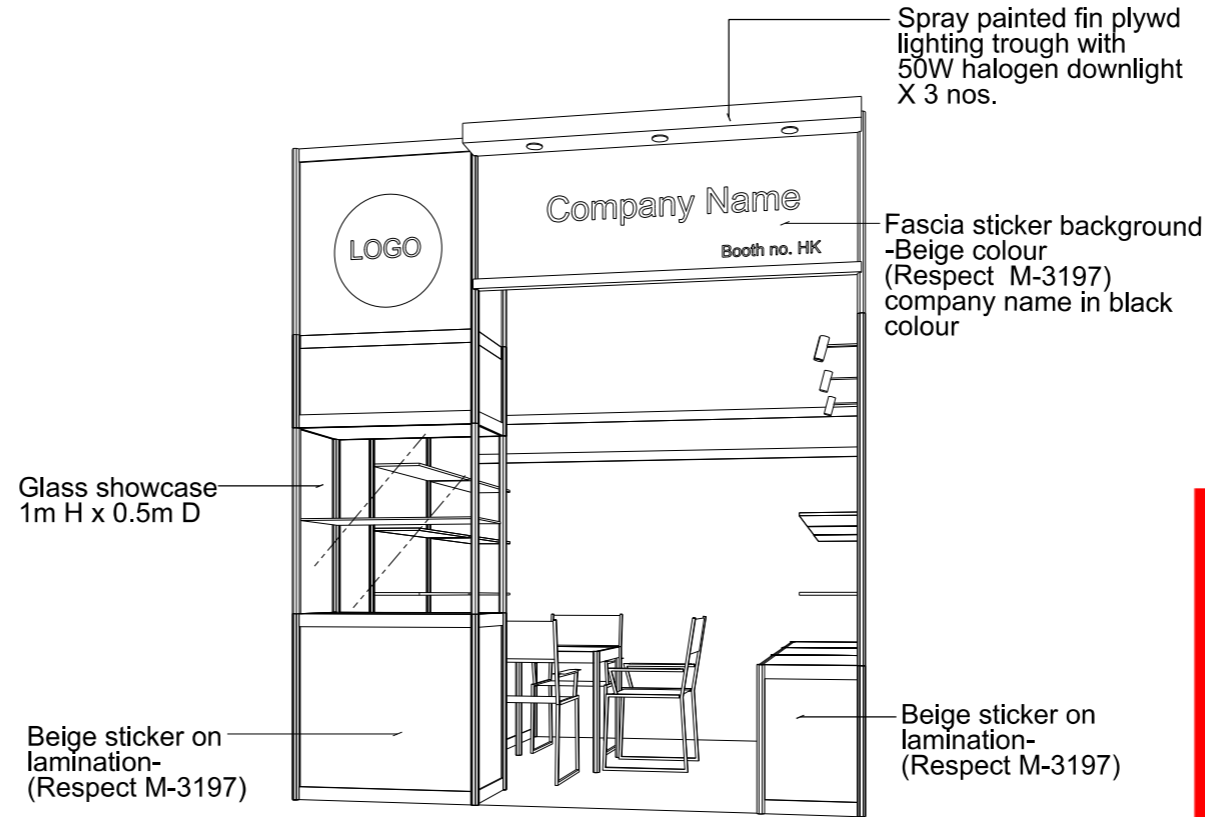

PERSPECTIVE N.T.S

IMPORTANT NOTICE
AMENDMENT OF BOOTH LIGHTING SPECIFICATIONS

ALL LIGHTS SPECIFIED AS 23 WATT ENERGY SAVING LAMPS (BOTH SPOTLIGHT/LONGARMED) ON THIS DRAWING WILL BE CHANGED TO **13 WATT LED LAMPS**, WITH EFFECT ON THE 1ST OF JANUARY 2019.

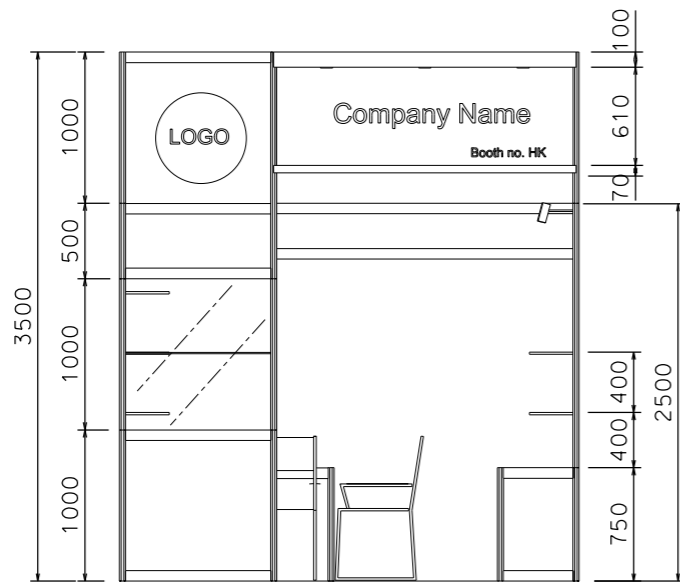

ELEVATION A

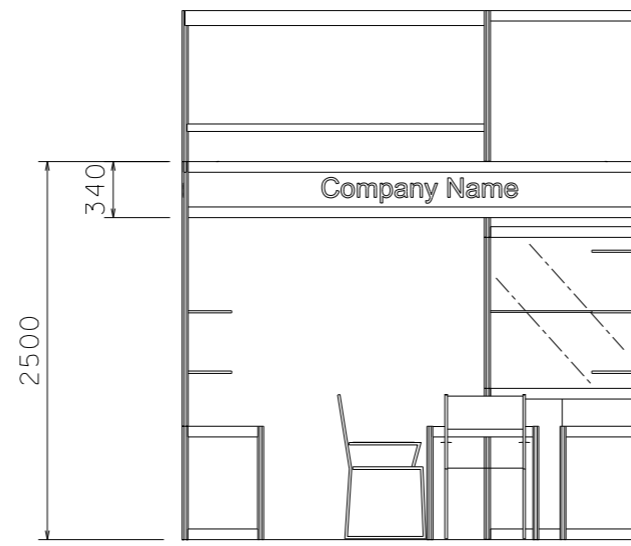

ELEVATION B

BOOTH SPECIFICATION		QTY
	Tall showcase in beige sticker lamination, 1 layer of glass shelf, 2x 50W halogen downlights	1
	Lockable cabinet in beige sticker lamination (1mL x 0.5mD x 0.75mH)	5
	Wooden shelf (flat) (1mL x 0.3mD)	12
	Square meeting table (0.7m X0.7m x 0.75mH)	1
	Black leather chair	3
	Longarmed spotlight w/23 watt energy saving lamp (yellow)	6
	50W Halogen light (for fascia)	3
	500w Square pin power socket	1
	Company Logo	1

FILE PATH - L:\Local Fair Premium Booth 2011\SD-Layouts\SD-A layout\SD-A-Layout-New.dgn

	NOTES UNLESS OTHERWISE SPECIFIED ALL DIMENSIONS ARE IN MM.	REVISION	DATE:	02-01-2018	TITLE Premium Booth SD-A-9	PROJECT PREMIUM BOOTH 3m x 3m DATE: XXXXXXXX	SHEET SD-A01d
	SCALE:	1 : 50 (A3)			
	DRAWN BY:	..			
	CHECKED BY:			

IMPORTANT NOTICE
AMENDMENT OF BOOTH LIGHTING SPECIFICATIONS

ALL LIGHTS SPECIFIED AS 23 WATT ENERGY SAVING LAMPS (BOTH SPOTLIGHT/LONGARMED) ON THIS DRAWING WILL BE CHANGED TO **13 WATT LED LAMPS**, WITH EFFECT ON THE 1ST OF JANUARY 2019.

Premium Booth 3mW x 3mD Left side Corner Booth

SD-A-9-L Cnr
 3mW x 3mD x 3.5mH

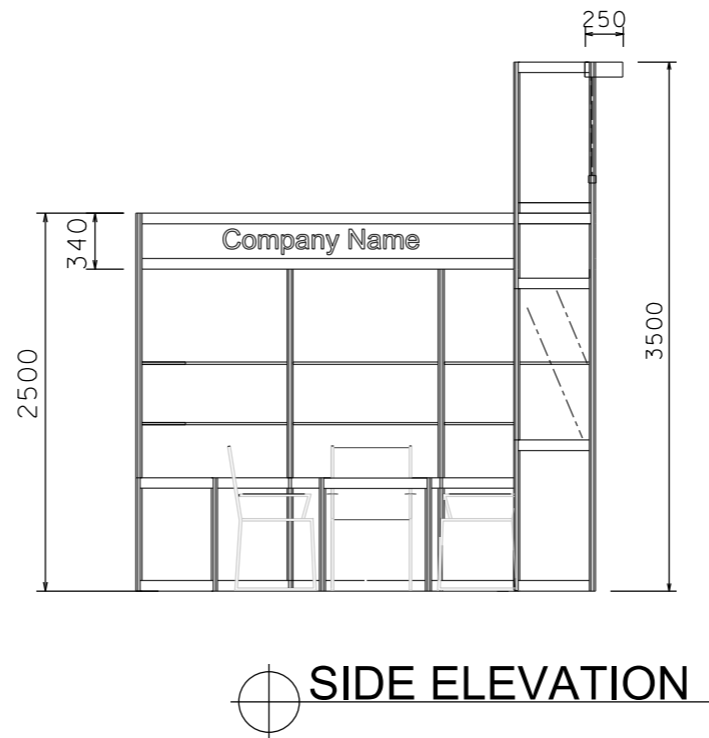
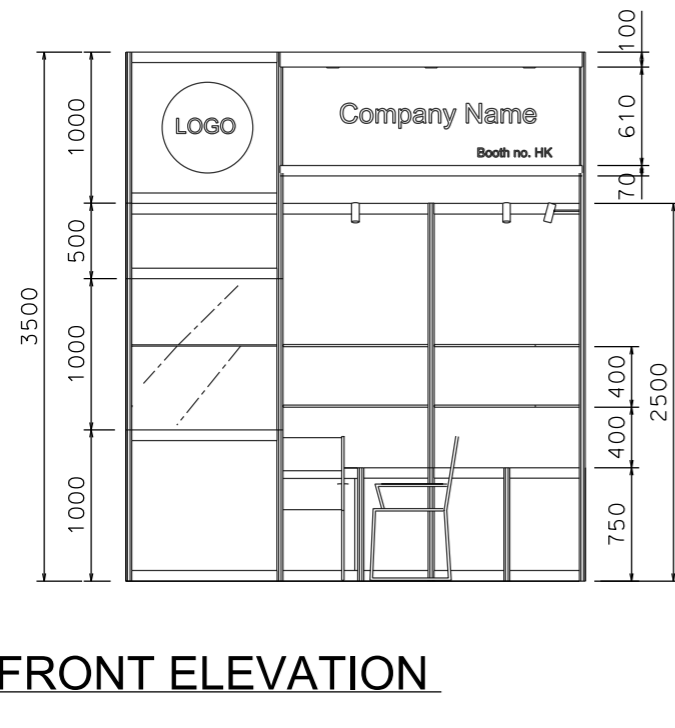
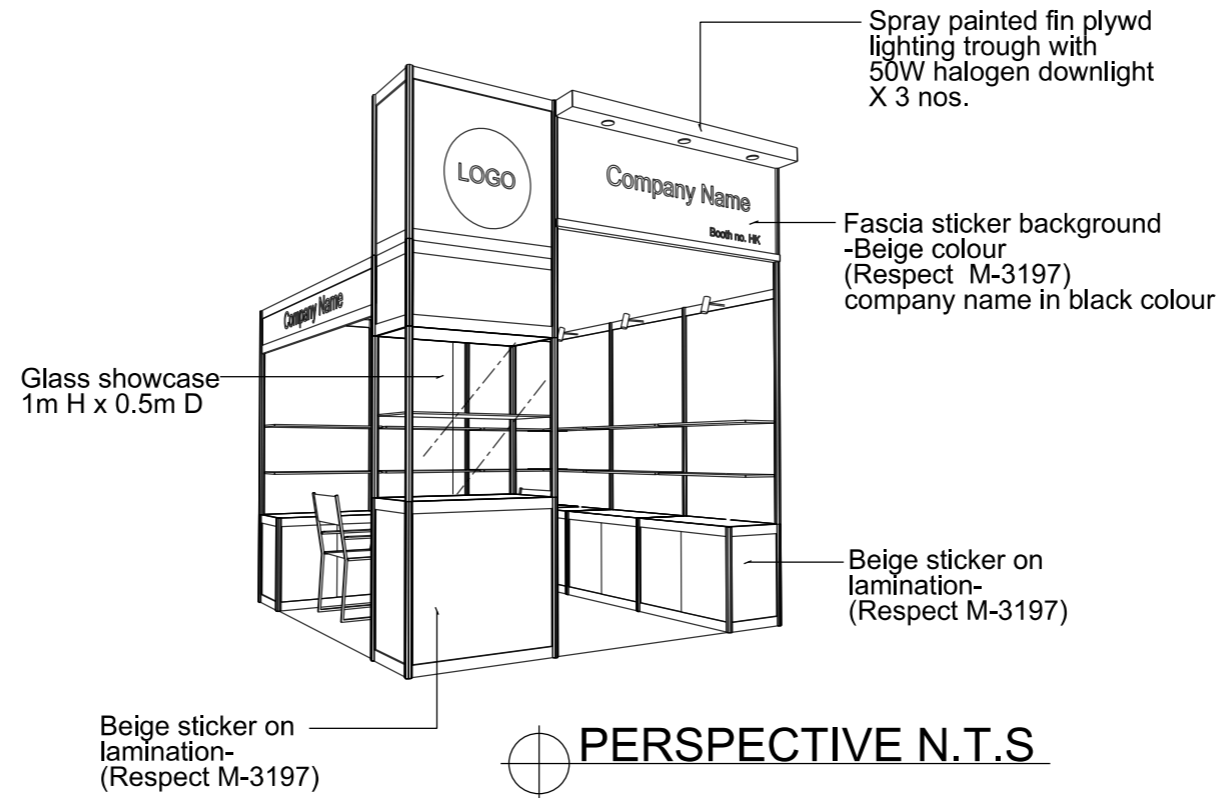
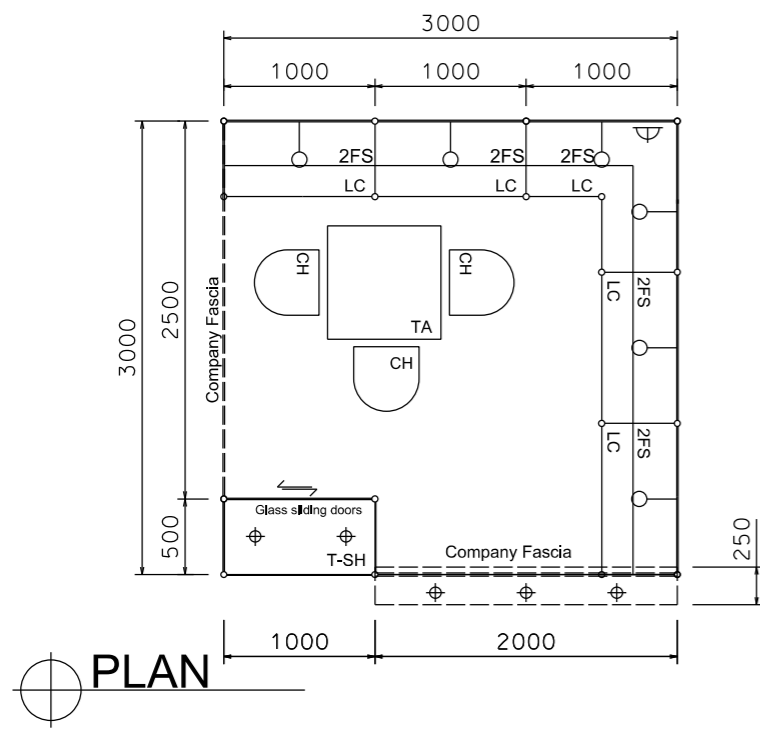

BOOTH SPECIFICATION		QTY
	Tall showcase in beige sticker lamination, 1 layer of glass shelf, 2x 50W halogen downlights	1
	Lockable cabinet in beige sticker lamination (1mL x 0.5mD x 0.75mH)	5.5
	Wooden shelf (flat) (1mL x 0.3mD)	12
	Square meeting table (0.7m X0.7m x 0.75mH)	1
	Black leather chair	3
	Longarmed spotlight w/23 watt energy saving lamp (yellow)	6
	50W Halogen light (for fascia)	3
	500w Square pin power socket	1
	Company Logo	1

FILE PATH - L:\Local Fair Premium Booth 2011\SD-Layouts\SD-A layout\SD-A-Layout-New.dgn



NOTES UNLESS OTHERWISE SPECIFIED ALL DIMENSIONS ARE IN MM.

.....

REVISION
26-11-08
15-12-08
31-12-2008
15-01-2009
09-02-2009
18-05-2009
15-07-2009
21-01-2010
05-05-2015

DATE:	21-01-2010
SCALE:	1 : 50 (A3)
DRAWN BY:	..
CHECKED BY:

TITLE
 Premium Booth
 SD-A-9-L
 Corner

PROJECT
 PREMIUM BOOTH
 3m x 3m Corner
 DATE: XXXXXXXX

SHEET
 SD-A01a

ALL LIGHTS SPECIFIED AS 23 WATT ENERGY SAVING LAMPS (BOTH SPOTLIGHT/LONGARMED) ON THIS DRAWING WILL BE CHANGED TO **13 WATT LED LAMPS**, WITH EFFECT ON THE 1ST OF JANUARY 2019.

Premium Booth 3mW x 3mD Right side Corner Booth

SD-A-9-R Cnr
 3mW x 3mD x 3.5mH

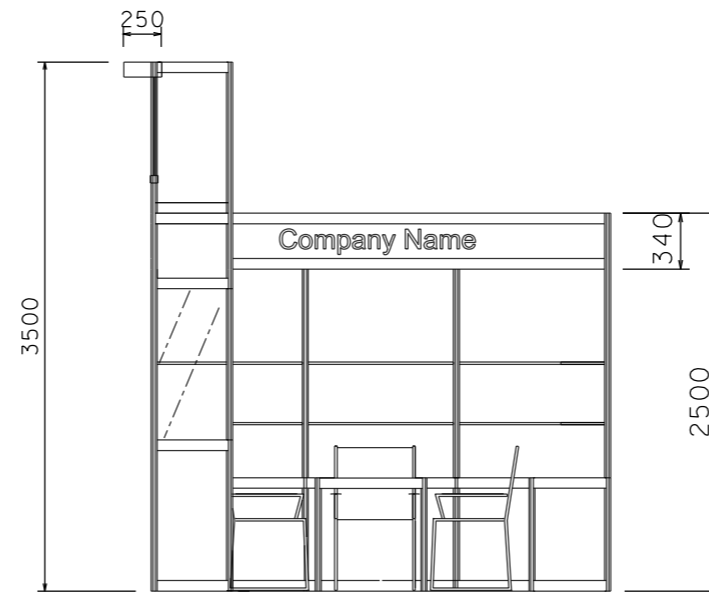
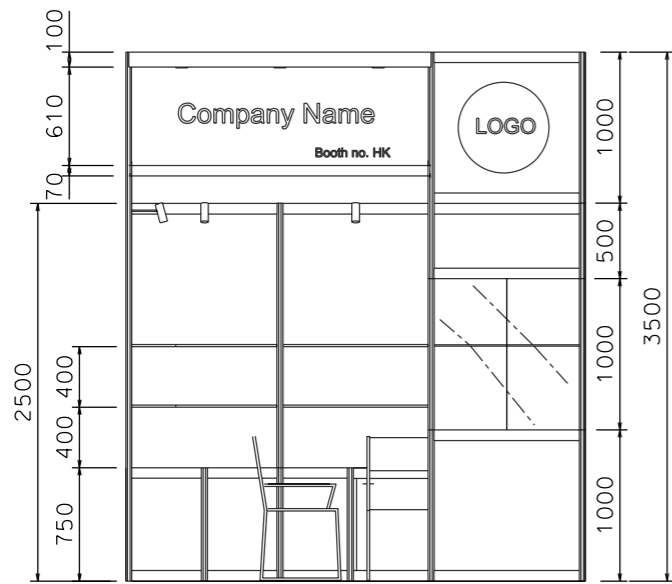
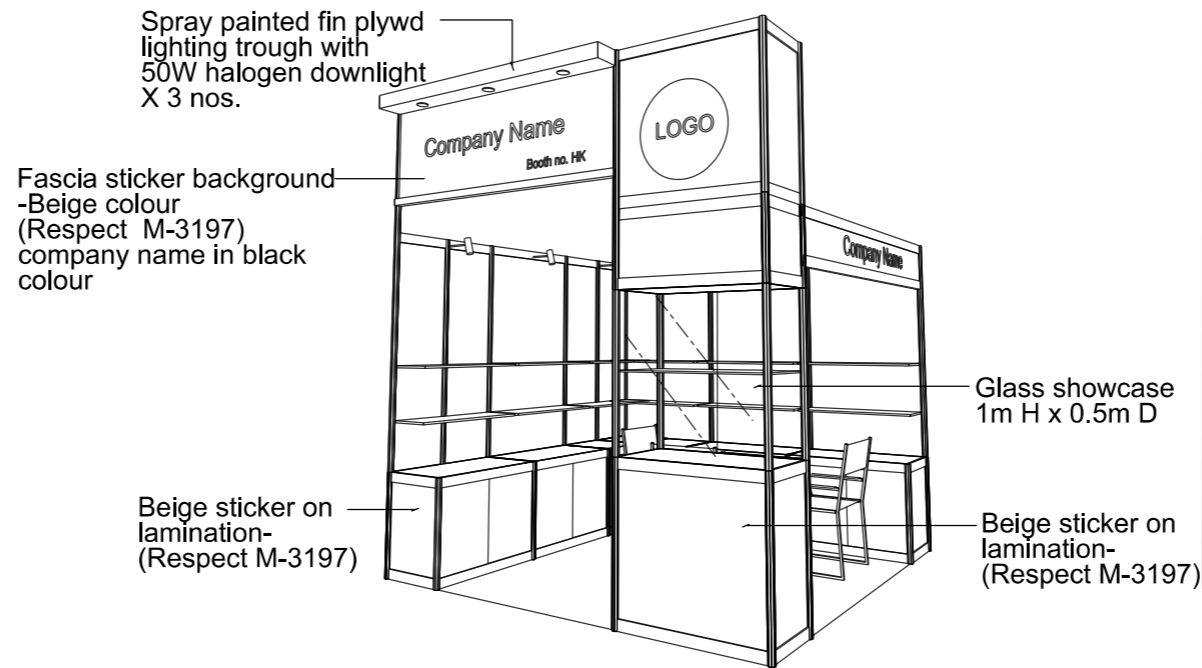
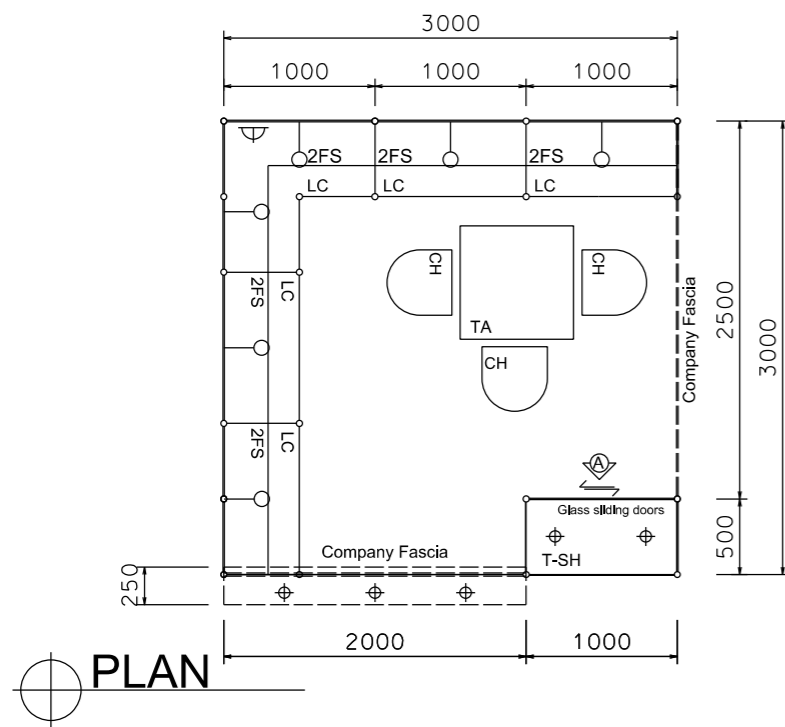

BOOTH SPECIFICATION		QTY
	Tall showcase in beige sticker lamination, 1 layer of glass shelf, 2x 50W halogen downlights	1
	Lockable cabinet in beige sticker lamination (1mL x 0.5mD x 0.75mH)	5.5
	Wooden shelf (flat) (1mL x 0.3mD)	12
	Square meeting table (0.7m X0.7m x 0.75mH)	1
	Black leather chair	3
	Longarmed spotlight w/23 watt energy saving lamp (yellow)	6
	50W Halogen light (for fascia)	3
	500w Square pin power socket	1
	Company Logo	1

FILE PATH - L:\Local Fair Premium Booth 2011\SD-Layouts\SD-A layout\SD-A-Layout-New.dgn



NOTES UNLESS OTHERWISE SPECIFIED ALL DIMENSIONS ARE IN MM.

.....

REVISION
 26-11-08
 31-12-2008
 15-01-2009
 09-02-2009
 18-05-2009
 15-07-2009
 21-01-2010
 05-05-2015

DATE: 21-01-2010
 SCALE: 1 : 50 (A3)
 DRAWN BY: ..
 CHECKED BY:

TITLE
 Premium Booth
 SD-A-9-R
 Corner

PROJECT
 PREMIUM BOOTH
 3m x 3m Corner
 DATE: XXXXXXXX

SHEET
 SD-A01b

Premium Booth 3mW x 3mD 3-side Open Booth

SD-A-9-3 SIDES OPEN
3mW x 3mD x 3.5mH

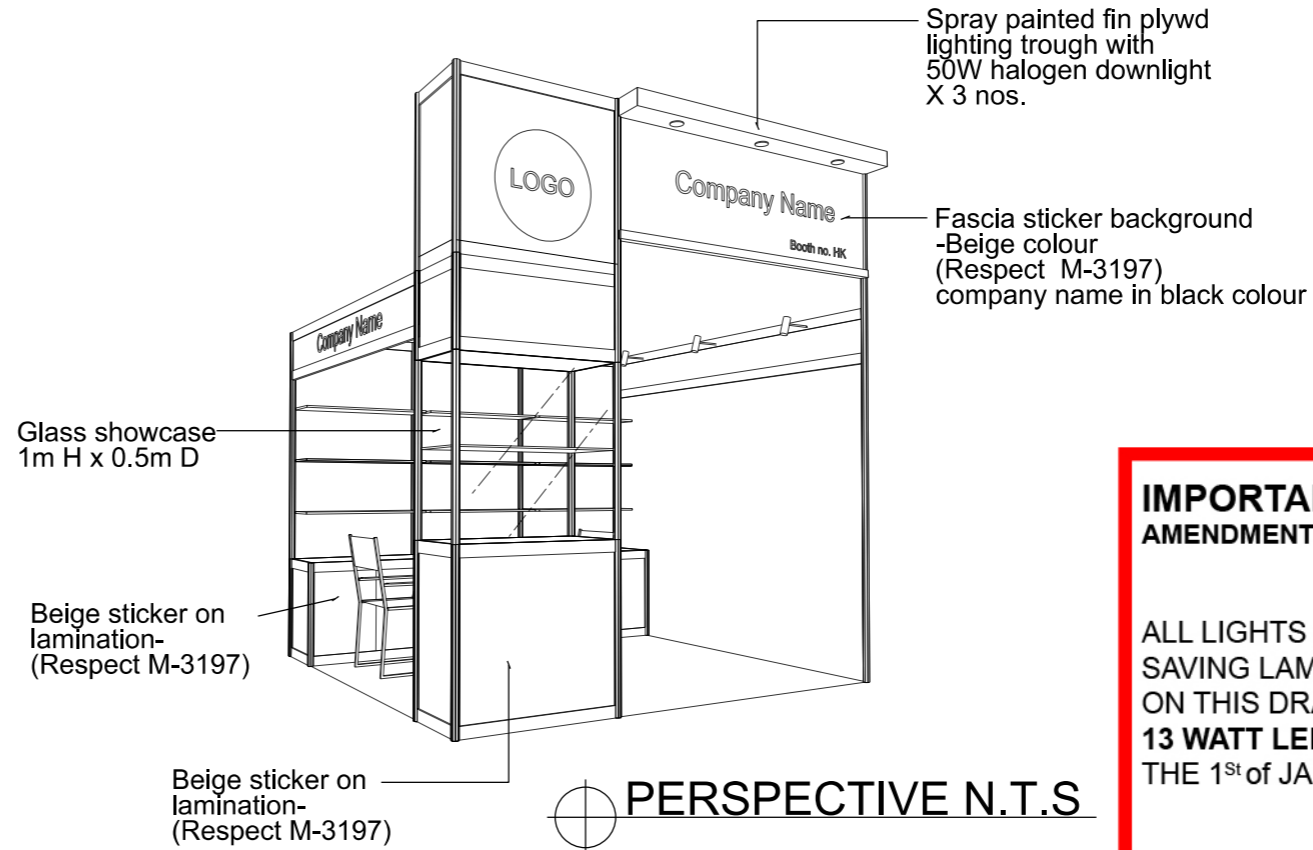
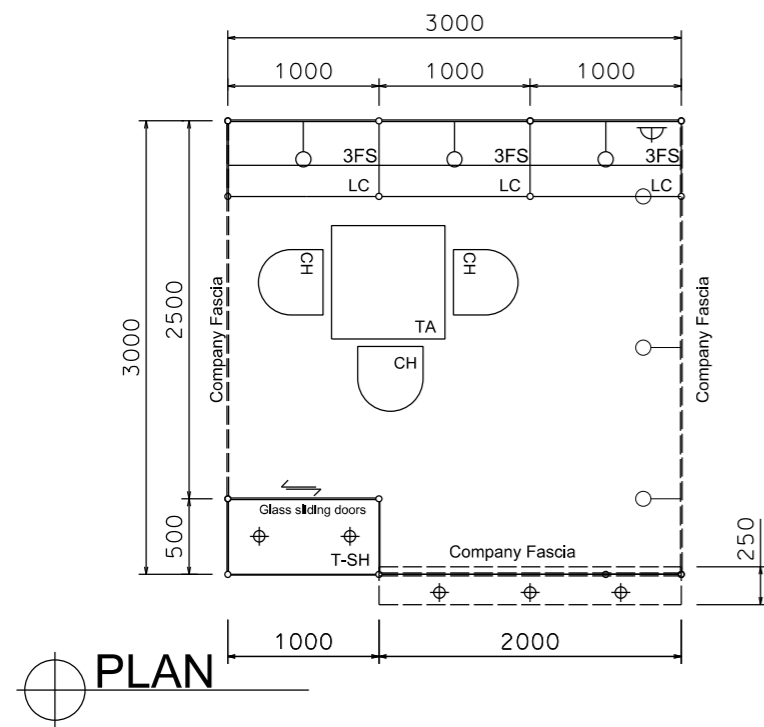

IMPORTANT NOTICE
AMENDMENT OF BOOTH LIGHTING SPECIFICATIONS

ALL LIGHTS SPECIFIED AS 23 WATT ENERGY SAVING LAMPS (BOTH SPOTLIGHT/LONGARMED) ON THIS DRAWING WILL BE CHANGED TO **13 WATT LED LAMPS**, WITH EFFECT ON THE 1ST OF JANUARY 2019.

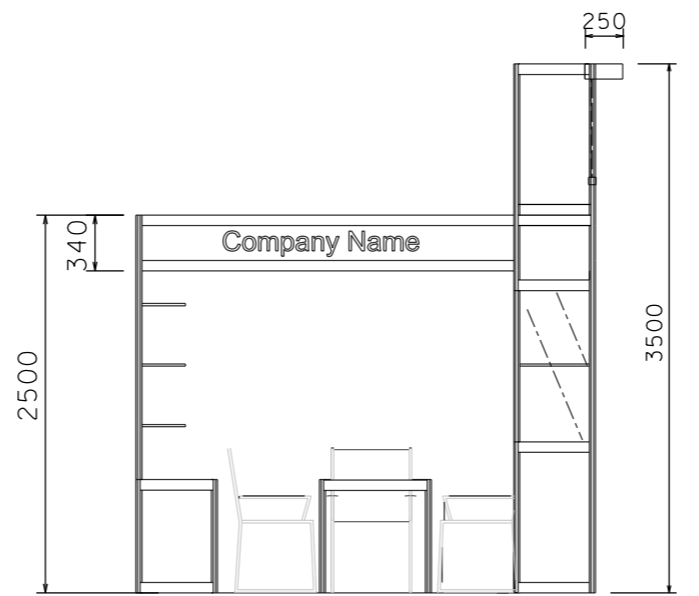
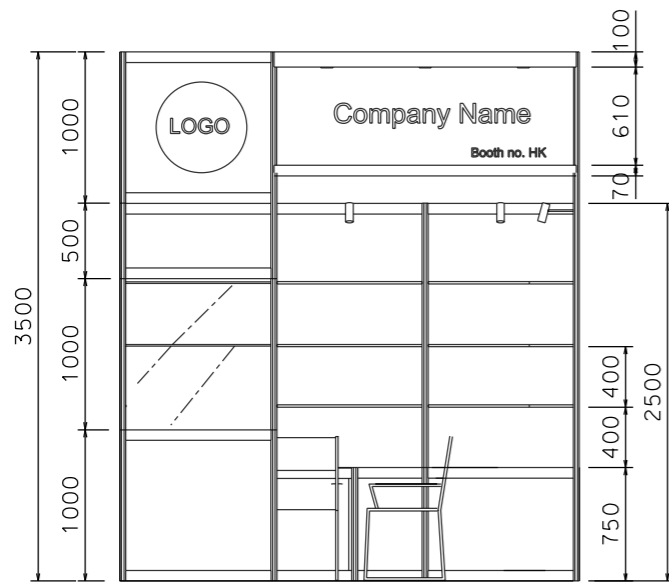

BOOTH SPECIFICATION	QTY
Tall showcase in beige sticker lamination, 1 layer of glass shelf, 2x 50W halogen downlights	1
Lockable cabinet in beige sticker lamination (1mL x 0.5mD x 0.75mH)	3
Wooden shelf (flat) (1mL x 0.3mD)	9
Square meeting table (0.7m X0.7m x 0.75mH)	1
Black leather chair	3
Longarmed spotlight w/23 watt energy saving lamp (yellow)	6
50W Halogen light (for fascia)	3
500w Square pin power socket	1
Company Logo	1

FRONT ELEVATION

SIDE ELEVATION

FILE PATH - L:\Local Fair Premium Booth 2011\SD-Layouts\SD-A layout\SD-A-Layout-New.dgn



NOTES UNLESS OTHERWISE SPECIFIED ALL DIMENSIONS ARE IN MM.

.....

.....

.....

REVISION
11/11/2011 ..

DATE: 11/11/2011

SCALE: 1 : 50 (A3)

DRAWN BY: ..

CHECKED BY:

TITLE

Premium Booth
SD-A-9-3
3 SIDES

PROJECT

PREMIUM BOOTH
3m x 3m
3 SIDES

DATE: XXXXXXXX

SHEET

SD-A01c